



## **UNIT SKYLIGHT CATALOG**

---

Insulated Curb Skylights

# **Table of Contents**

## **Standard 9" High Frame Skylights**

- 12. **ACST-9:** Insulated Curb, 9" Unit Height, Double Dome
- 13. **ACST-9-PC-PANEL:** Insulated Curb, 9" Frame Height, Multi Wall Polycarbonate Panel
- 14. **ACIG-9-TB:** Insulated Curb, 9" Frame Height, Insulated Glass, Thermal Break Curb Frame
- 15. **ACIG-9:** Insulated Curb, 9" Frame Height, Insulated Glass

## **Standard 9" High Frame Skylights with FTP**

- 16. **ACST -9-FTP:** Insulated Curb, 9" Frame Height, Double Dome, Fall Through Protection
- 17. **ACST-9-TB-FTP:** Insulated Curb, 9" Frame Height, Double Dome, Fall Through Protection, Thermal Break Curb Frame
- 18. **ACST-9-PRZ-FTP:** Insulated Curb, 9" Frame Height, Double Prismatic Polycarbonate Dome, Fall Through Protection
- 19. **ACST-9-TB-PRZ-FTP:** Insulated Curb, 9" Frame Height Curb Frame, Double Prismatic Polycarbonate Dome, Fall Through Protection

## **Table of Contents (cont'd)**

### **Standard 9" High Curb Skylights with Wood Nailers**

- [20. \*\*ICW-CMDD:\*\* 9" High Insulated Curb with Wood Nailer and Aluminum Liner & Separate Curb Mount, Double Dome Skylight](#)
- [21. \*\*ICW-CMDD-FTP:\*\* 9" High Insulated Curb with Wood Nailer and Aluminum Liner & Separate Curb Mount Double Dome Skylight with OSHA Compliant Fall Through Protection](#)
- [22. \*\*ICW-CMDD-PRZ-FTP:\*\* 9" High Insulated Curb with Wood Nailer and Aluminum Liner & Separate Curb Mount Double Prismatic Dome with OSHA Compliant Fall Through Protection](#)

### **Skylights with 12" High (or Custom Height) Formed Aluminum Curbs**

- [23. \*\*CMDD-IC:\*\* Curb Mount Double Dome Skylight with 12" High Insulated Curb with Interior Liner](#)
- [24. \*\*CMDD-IC-FTP:\*\* Curb Mount, Double Dome, OSHA Compliant Fall Through Protection Skylight and 12" High Insulated Curb with Liner](#)
- [25. \*\*CMDD-PRZ-FTP-IC:\*\* Curb Mount, Double Polycarbonate Prismatic Dome, OSHA Compliant Fall Through Protection Skylight and Insulated Curb with Interior Aluminum Curb Liner](#)

## Table of Contents (cont'd)

### **Skylights with 12" High (or Custom Height) Formed Aluminum Curbs (cont'd)**

26. **LRV-IC:** Low Rise Vault on 12" High Insulated Curb

26.1. **LRV-IC:** Low Rise Vault with Acrylic Panels and Aluminum Frame, 12" High  
Insulated Curb, with Interior Liner

# 12. ACST-9: Insulated Curb, 9" Unit Height, Double Dome

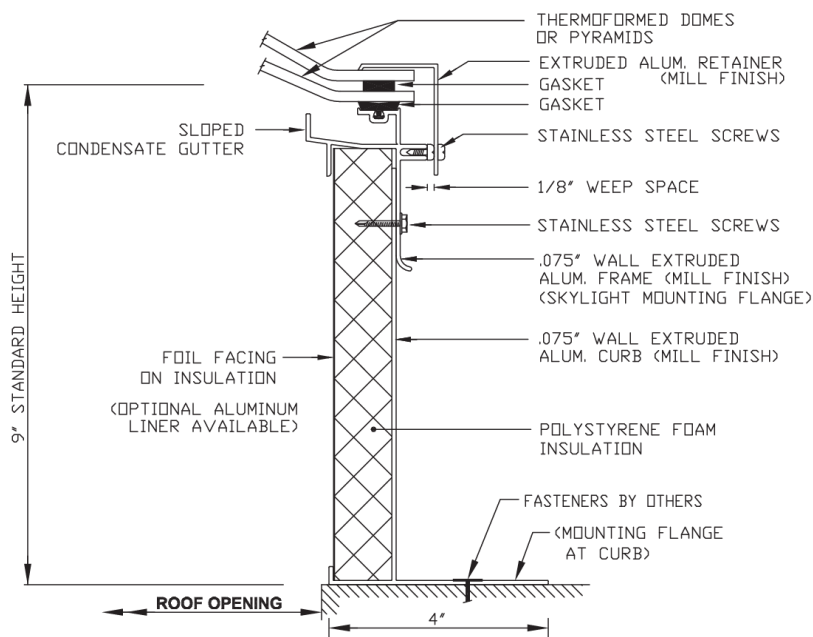

PERIMETER SECTION-SKYLIGHT  
1/2"=1'

## MODEL ACST-9

INSULATED CURB (DOUBLE DOME)

EXARC'S MODEL ACST-9, IS A UNIT SKYLIGHT WITH AN INTEGRAL INSULATED ALUMINUM CURB. THE CURB AND SKYLIGHT ARE PERMANENTLY ATTACHED AT THE FACTORY AND ARE NOT DESIGNED FOR FIELD DISASSEMBLY BY OTHERS. CURB FLASHING BY OTHERS MUST TERMINATE BELOW THE BOTTOM EDGE OF THE SKYLIGHT MOUNTING FLANGE. IF IN FACT THE PROJECT FLASHING DESIGN AT THE SKYLIGHT CURB REQUIRES THE FLASHING TO EXTEND UP AND UNDER THE SKYLIGHT MOUNTING FLANGE, PLEASE INDICATE ON THE DRAWING AND EXARC CAN SUPPLY AN APPROPRIATE TYPE CURB / SKYLIGHT ATTACHMENT DETAIL.

DO NOT SIT, STAND, OR WALK ON SKYLIGHTS. DO NOT PLACE OBJECTS ONTO SKYLIGHTS OR REST ANY TYPE MATERIAL ON OR AGAINST SKYLIGHTS.

## SPECIFICATIONS: MODEL ACST-9

<b>MODEL:</b> ACST-9	EXARC DESIGN, FACTORY ASSEMBLED, ALUMINUM FRAME, SELF CURBING COMMERCIAL SKYLIGHT TO FIT OVER SPECIFIED SIZE ROOF OPENING. GLAZING TO BE THERMOFORMED, DOMES OR PYRAMIDS. ALUMINUM FRAME DESIGN TO HAVE A SLOPED CONDENSATION GUTTER WITH PROVISION TO WEEP MOISTURE TO THE EXTERIOR AND AN INTEGRAL INSULATED CURB WITH INTERIOR FOIL THERMAL LINER. 2-3/4" WIDE MOUNTING FLANGE ALL AROUND THE PERIMETER BASE. OVERALL SKYLIGHT FRAME STANDARD HEIGHT 9" (AVAILABLE FROM 6" TO 9") OPTIONAL ALUMINUM LINER AVAILABLE FOR INTERIOR OF CURB.
<b>GLAZING:</b>	THERMOFORMED ACRYLIC OR POLYCARBONATE DOME OR PYRAMID (OUTER LITE) THERMOFORMED ACRYLIC OR POLYCARBONATE DOME OR PYRAMID (INNER LITE) COLOR OPTIONS: CLEAR/ CLEAR, CLEAR/ WHITE, BRONZE/ CLEAR
<b>FINISH:</b>	MILL FINISH (STANDARD)
<b>ALUMINUM:</b>	EXTRUDED 6063-T5, CURB AND GLAZING FRAME .075", GLAZING RETAINER .065"
<b>FASTENERS:</b>	STAINLESS STEEL. ALL FASTENERS NATURAL FINISH.
<b>GASKET:</b>	EXTRUDED EPDM (BLACK)
<b>SHIPPING:</b>	FACTORY ASSEMBLED UNITS, READY TO MOUNT OVER ROOF OPENING BY OTHERS
<b>INSTALLATION:</b>	BY OTHERS (MOUNTING FASTENERS BY OTHERS)

<b>DESIGN:</b>	DESIGN LOADS PER LOCAL CODES OR PER PROJECT SPECIFICATIONS - GLAZING THICKNESS AND THERMOFORMED HEIGHT OF DOMES OR PYRAMIDS TO CONFORM TO RECOMMENDATIONS IN AAMA 1601-76 AND AAMA 1603-93.
----------------	---------------------------------------------------------------------------------------------------------------------------------------------------------------------------------------------

<b>SAFETY:</b>	FALL THROUGH AND BREAKAGE - STANDARD DESIGN ACRYLIC OR POLYCARBONATE GLAZING ARE NOT INTENDED TO SUPPORT THE WEIGHT OF A PERSON OR ANY OTHER LOAD IMPOSED UPON THE SKYLIGHT. IF THE PROJECT LOCATION INDICATES THAT THE SKYLIGHTS MAY BE SUBJECTED TO INCIDENTAL OR UNINTENDED LIVE LOADS, OR IF THE PROJECT SKYLIGHT SPECIFICATIONS INDICATE THAT OSHA APPROVED FALL THROUGH PROTECTION ARE TO BE INTEGRAL TO THE SKYLIGHT DESIGN, EXARC CAN SUPPLY LABORATORY TESTED GLAZING OR PROTECTIVE SCREEN COVERS THAT ARE IN COMPLIANCE WITH OSHA FALL THROUGH PROTECTION REQUIREMENTS. SEE OUR SKYLIGHTS THAT INCLUDE "FTT" IN THE MODEL NUMBER.
----------------	------------------------------------------------------------------------------------------------------------------------------------------------------------------------------------------------------------------------------------------------------------------------------------------------------------------------------------------------------------------------------------------------------------------------------------------------------------------------------------------------------------------------------------------------------------------------------------------------------------------------------------------------

STANDARD SIZES:	UNIT NO.	ROOF OPENING (RECTANGULAR)	UNIT NO.	ROOF OPENING (SQUARE)	GLAZING OPTIONS MODEL NUMBERS
	3672	32" X 68"	4848	44" X 44"	ACST-9 DOUBLE DOME
	3696	32" X 92"	5252	48" X 48"	ACS-9 SINGLE DOME
	4872	44" X 68"	6060	56" X 56"	ACST-9P DOUBLE PYRAMID
	4896	44" X 92"	7272	68" X 68"	ACS-9P SINGLE PYRAMID
	5276	48" X 72"	9696	92" X 92"	
<b>NOTE:</b> ANY CUSTOM SIZE IS AVAILABLE UP TO 98" X 98" ROOF OPENING	5296	48" X 92"			
	52102	48" X 98"			

<b>ORDERING INFORMATION:</b>	INDICATE THE FOLLOWING: ROOF OPENING SIZE - GLAZING MATERIAL REQUIRED - DOME OR PYRAMID SHAPED GLAZING -	GLAZING COLOR- UNIT HEIGHT - QUANTITY-
------------------------------	-------------------------------------------------------------------------------------------------------------------	----------------------------------------------



EXARC SKYLIGHTS, INC.  
3793-B NORTH PEACHTREE RD.  
CHAMBLEE, GA 30341

770-451-4352  
800-247-5934  
FAX: 770-451-4934

WEBSITE: [www.exarcskylights.com](http://www.exarcskylights.com)

EMAIL: [info@exarcskylights.com](mailto:info@exarcskylights.com)

12C



EXARC SKYLIGHTS, INC.  
3793-B NORTH PEACHTREE RD.  
CHAMBLEE, GA 30341

WEBSITE: [www.exarcskylights.com](http://www.exarcskylights.com)

770-451-4352  
800-247-5934  
FAX: 770-451-4934

EMAIL: [info@exarcskylights.com](mailto:info@exarcskylights.com)

12S

PROJECT:  
CONTRACTOR:

DATE:

PAGE 1 OF 2

PROJECT:  
CONTRACTOR:

DATE:

PAGE 2 OF 2

# 13. ACST-9-PC-PANEL: Insulated Curb, 9" Frame Height, Multi Wall Polycarbonate Panel

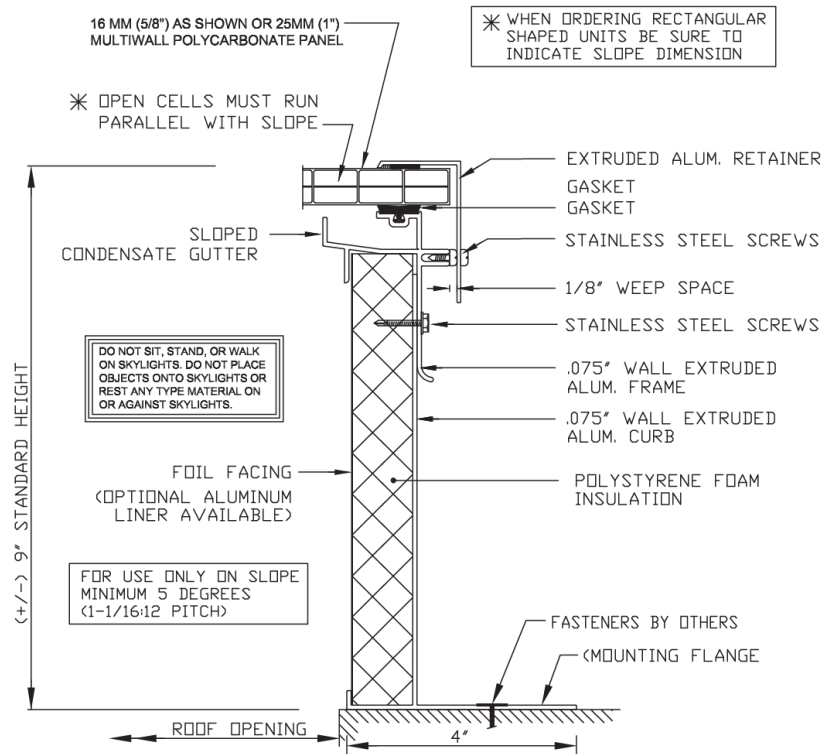

## MODEL ACST-9- PC PANEL

INSULATED CURB  
-(POLYCARBONATE PANEL)

EXARC'S MODEL ACST-9, IS A UNIT SKYLIGHT WITH AN INTEGRAL INSULATED ALUMINUM CURB. THE CURB AND SKYLIGHT ARE PERMANENTLY ATTACHED AT THE FACTORY AND ARE NOT DESIGNED FOR FIELD DISASSEMBLY BY OTHERS. CURB FLASHING BY OTHERS MUST TERMINATE BELOW THE BOTTOM EDGE OF THE SKYLIGHT MOUNTING FLANGE. IF IN FACT THE PROJECT FLASHING DESIGN AT THE SKYLIGHT CURB REQUIRES THE FLASHING TO EXTEND UP AND UNDER THE SKYLIGHT MOUNTING FLANGE, PLEASE INDICATE ON THE DRAWING AND EXARC CAN SUPPLY AN APPROPRIATE TYPE CURB / SKYLIGHT ATTACHMENT DETAIL.

13C



EXARC SKYLIGHTS, INC.  
3793-B NORTH PEACHTREE RD.  
CHAMBLEE, GA 30341

WEBSITE: [www.exarcskylights.com](http://www.exarcskylights.com)

770-451-4352  
800-247-5934  
FAX: 770-451-4934

EMAIL: [info@exarcskylights.com](mailto:info@exarcskylights.com)

PROJECT:

CONTRACTOR:

DATE:

PAGE 1 OF 2

## SPECIFICATIONS: MODEL ACST-9-PC PANEL

MODEL: ACST-9- PC PANEL	EXARC DESIGN, FACTORY ASSEMBLED, ALUMINUM FRAME, SELF CURBING COMMERCIAL SKYLIGHT TO FIT OVER SPECIFIED SIZE ROOF OPENING. GLAZING TO BE RIBBED MULTI WALL POLYCARBONATE PANELS. ALUMINUM FRAME DESIGN TO HAVE A SLOPED CONDENSATION GUTTER WITH PROVISION TO WEEP MOISTURE TO THE EXTERIOR AND AN INTEGRAL INSULATED CURB WITH INTERIOR FOIL THERMAL LINER. 2-3/4" WIDE MOUNTING FLANGE ALL AROUND THE PERIMETER BASE. OVERALL SKYLIGHT FRAME STANDARD HEIGHT 9" (AVAILABLE FROM 6" TO 9") OPTIONAL ALUMINUM LINER AVAILABLE FOR INTERIOR OF CURB.
GLAZING:	16MM (5/8") RIBBED MULTI WALL POLYCARBONATE PANEL 25MM (1") RIBBED MULTI WALL POLYCARBONATE PANEL (PANEL THICKNESS TO SUIT LOADING REQUIREMENTS OR PROJECT SPECIFICATIONS) COLOR OPTIONS: CLEAR, WHITE TRANSLUCENT, BRONZE TINTED
FINISH:	MILL FINISH (STANDARD)
ALUMINUM:	EXTRUDED 6063-T5, CURB AND GLAZING FRAME .075", GLAZING RETAINER .065"
FASTENERS:	STAINLESS STEEL. ALL FASTENERS NATURAL FINISH.
GASKET:	EXTRUDED EPDM (BLACK)
SHIPPING:	FACTORY ASSEMBLED UNITS, READY TO MOUNT OVER ROOF OPENING BY OTHERS
INSTALLATION:	BY OTHERS (MOUNTING FASTENERS BY OTHERS)
DESIGN:	DESIGN LOADS PER LOCAL CODES OR PER PROJECT SPECIFICATIONS
SAFETY:	FALL THROUGH AND BREAKAGE - STANDARD DESIGN RIBBED MULTI WALL POLYCARBONATE GLAZING IS NOT INTENDED TO SUPPORT THE WEIGHT OF A PERSON OR ANY OTHER LOAD IMPOSED UPON THE SKYLIGHT. IF THE PROJECT LOCATION INDICATES THAT THE SKYLIGHTS MAY BE SUBJECTED TO INCIDENTAL OR UNINTENDED LIVE LOADS, OR IF THE PROJECT SKYLIGHT SPECIFICATIONS INDICATE THAT OSHA APPROVED FALL THROUGH PROTECTION ARE TO BE INTEGRAL TO THE SKYLIGHT DESIGN, EXARC CAN SUPPLY PROTECTIVE SCREEN COVERS THAT ARE IN COMPLIANCE WITH OSHA FALL THROUGH PROTECTION REQUIREMENTS.

STANDARD SIZES:	UNIT NO.	ROOF OPENING
NOTE: ANY CUSTOM SIZE IS AVAILABLE UP TO 44" WIDE X 116" SLOPE LENGTH ROOF OPENING	3672	32" WIDTH X 68" SLOPE LENGTH
	3696	32" WIDTH X 92" SLOPE LENGTH
	36120	32" WIDTH X 116" SLOPE LENGTH
	4848	44" WIDTH X 44" SLOPE LENGTH
	4872	44" WIDTH X 68" SLOPE LENGTH
	4896	44" WIDTH X 92" SLOPE LENGTH
	48120	44" WIDTH X 116" SLOPE LENGTH

CROSS MEMBER SUPPORTS MAY BE REQUIRED ACROSS WIDTH TO MINIMIZE GLAZING DEFLECTION ON LARGER UNITS.

ORDERING INFORMATION:	INDICATE THE FOLLOWING: ROOF OPENING SIZE - INDICATE WHICH DIMENSION IS PARALLEL WITH THE SLOPE OF THE ROOF.	GLAZING COLOR-
		UNIT HEIGHT - QUANTITY-



EXARC SKYLIGHTS, INC.  
3793-B NORTH PEACHTREE RD.  
CHAMBLEE, GA 30341

WEBSITE: [www.exarcskylights.com](http://www.exarcskylights.com)

770-451-4352  
800-247-5934  
FAX: 770-451-4934

EMAIL: [info@exarcskylights.com](mailto:info@exarcskylights.com)

13S

PROJECT:

CONTRACTOR:

DATE:

PAGE 2 OF 2



# 14. ACIG-9-TB: Insulated Curb, 9" Frame Height, Insulated Glass, Thermal Break Curb Frame

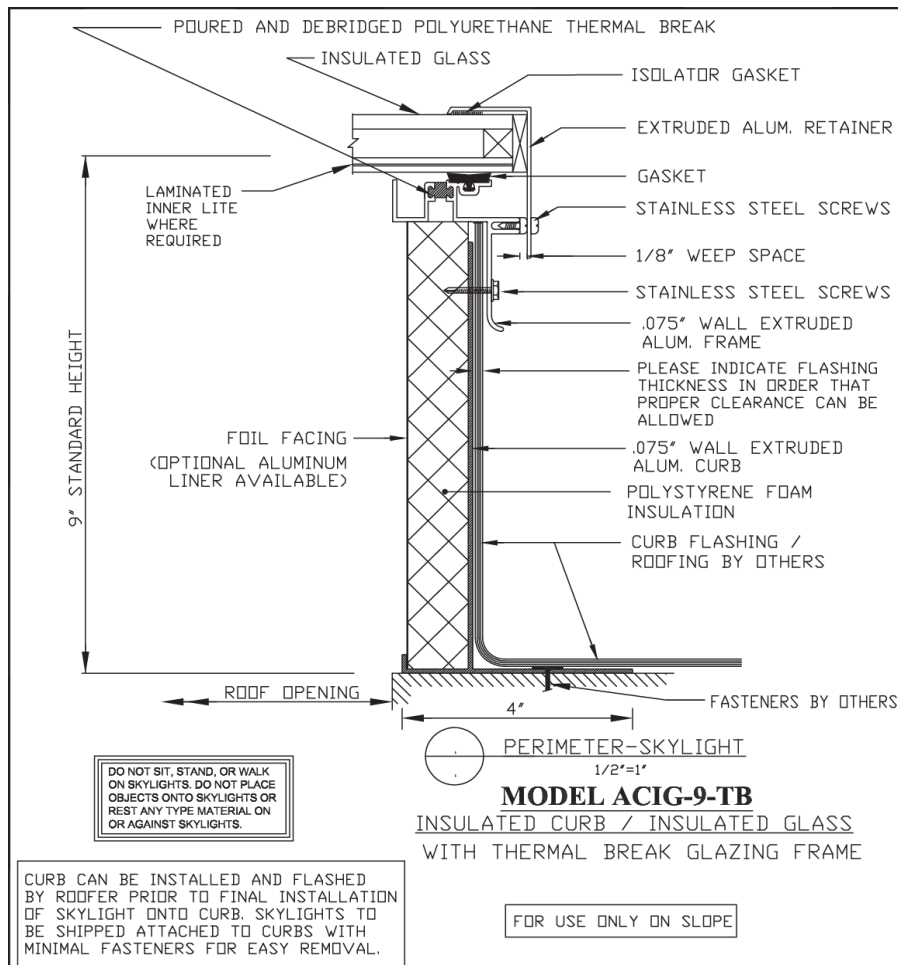

## SPECIFICATIONS: MODEL ACIG-9-TB

<b>MODEL:</b> ACIG-9-TB	EXARC DESIGN, FACTORY ASSEMBLED, ALUMINUM FRAME, SELF CURBING COMMERCIAL SKYLIGHT TO FIT OVER SPECIFIED SIZE ROOF OPENING. GLAZING TO BE INSULATED GLASS. ALUMINUM FRAME DESIGN WITH THERMAL BREAK AND PROVISION TO WEEP MOISTURE TO THE EXTERIOR. INSULATED CURB TO HAVE INTERIOR FOIL THERMAL LINER. 2-3/4" WIDE MOUNTING FLANGE ALL AROUND THE PERIMETER BASE. OVERALL SKYLIGHT FRAME STANDARD HEIGHT 9" (AVAILABLE FROM 6" TO 9" HEIGHTS OR TAPERED FROM 6" TO 9" ACROSS THE WIDTH FOR INSTALLATIONS ON LEVEL ROOFS) OPTIONAL ALUMINUM LINER AVAILABLE FOR INTERIOR OF CURB.
<b>GLAZING:</b>	TEMPERED OUTER LITE / AIR SPACE / TEMPERED OR LAMINATED INNER LITE ACTUAL GLAZING MAKEUP BASED ON UNIT SIZE AND PROJECT SPECIFICATIONS, COLOR OPTIONS: CLEAR, WHITE TRANSLUCENT, BRONZE, GREY, BLUE OR GREEN TINTED COATING CHOICES: LOW E (SEVERAL PERFORMANCE GRADES), REFLECTIVE COATINGS
<b>FINISH:</b>	MILL FINISH (STANDARD)
<b>ALUMINUM:</b>	EXTRUDED 6063-T5, CURB AND GLAZING FRAME .075", GLAZING RETAINER .065"
<b>FASTENERS:</b>	STAINLESS STEEL. ALL FASTENERS NATURAL FINISH.
<b>GASKET:</b>	EXTRUDED EPDM (BLACK)
<b>SHIPPING:</b>	FACTORY ASSEMBLED UNITS, READY TO MOUNT OVER ROOF OPENING BY OTHERS
<b>INSTALLATION:</b>	BY OTHERS (MOUNTING FASTENERS BY OTHERS)

<b>DESIGN:</b>	DESIGN LOADS PER LOCAL CODES OR PER PROJECT SPECIFICATIONS
<b>SAFETY:</b>	<b>FALL THROUGH AND BREAKAGE</b> - INSULATED GLASS IS NOT INTENDED TO SUPPORT THE WEIGHT OF A PERSON OR ANY OTHER LOAD IMPOSED UPON THE SKYLIGHT. IF THE PROJECT LOCATION INDICATES THAT THE SKYLIGHTS MAY BE SUBJECTED TO INCIDENTAL OR UNINTENDED LIVE LOADS, OR IF THE PROJECT SKYLIGHT SPECIFICATIONS INDICATE THAT OSHA APPROVED FALL THROUGH PROTECTION ARE TO BE INTEGRAL TO THE SKYLIGHT DESIGN, EXARC CAN SUPPLY PROTECTIVE SCREEN COVERS THAT ARE IN COMPLIANCE WITH OSHA FALL THROUGH PROTECTION REQUIREMENTS.

STANDARD SIZES:	UNIT NO.	ROOF OPENING
NOTE: ANY CUSTOM SIZE IS AVAILABLE UP TO 20 SQUARE FEET ROOF OPENING	2424	20" X 20"
	2436	20" X 32"
	2448	20" X 44"
	2472	20" X 68"
	3636	32" X 32"
	3648	32" X 44"

NOTE:  
INSULATED GLASS UNITS MAKE UP FOR SKYLIGHTS WITH ROOF OPENINGS UP TO 9.7 SQUARE FEET:  
3/4" INSULATED GLASS -  
3/16" TEMPERED OUTER LITE / 3/8" AIR SPACE / 3/16" TEMPERED INNER LITE.

FOR LARGER SKYLIGHTS THE GLAZING THICKNESS WILL INCREASE AND THE INNER LITE WILL BE LAMINATED

<b>ORDERING INFORMATION:</b>	INDICATE THE FOLLOWING: ROOF OPENING SIZE - GLAZING SPECIFICATION -	UNIT HEIGHT - QUANTITY -
------------------------------	---------------------------------------------------------------------------	-----------------------------

**EXARC**® EXARC SKYLIGHTS, INC. 770-451-4352  
3793-B NORTH PEACHTREE RD. 800-247-5934  
CHAMBLEE, GA 30341 FAX: 770-451-4934  
WEBSITE: www.exarcskylights.com EMAIL: info@exarcskylights.com

14C

PROJECT: DATE: PAGE 1 OF 2  
CONTRACTOR:

**EXARC**® EXARC SKYLIGHTS, INC. 770-451-4352  
3793-B NORTH PEACHTREE RD. 800-247-5934  
CHAMBLEE, GA 30341 FAX: 770-451-4934  
WEBSITE: www.exarcskylights.com EMAIL: info@exarcskylights.com

14S

PROJECT: DATE: PAGE 2 OF 2  
CONTRACTOR:

# 15. ACIG-9: Insulated Curb, 9" Frame Height, Insulated Glass

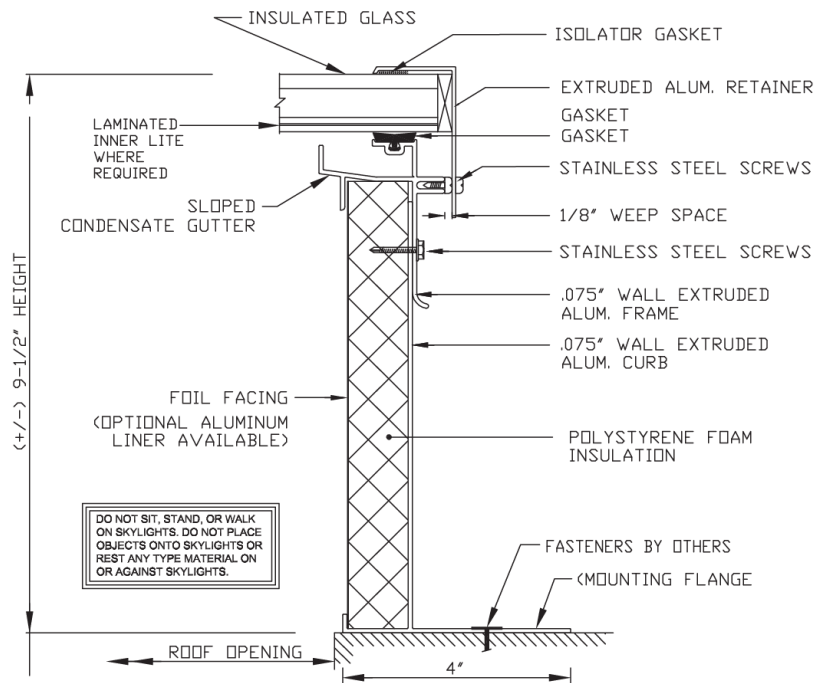

DO NOT SIT, STAND, OR WALK ON SKYLIGHTS. DO NOT PLACE OBJECTS ONTO SKYLIGHTS OR REST ANY TYPE MATERIAL ON OR AGAINST SKYLIGHTS.



PERIMETER-SKYLIGHT  
1/2"±1"

**MODEL ACIG-9**  
**INSULATED CURB**  
**INSULATED GLASS**

FOR USE ONLY ON SLOPE

EXARC'S MODEL ACIG-9, IS A UNIT SKYLIGHT WITH AN INTEGRAL INSULATED ALUMINUM CURB. THE CURB AND SKYLIGHT ARE PERMANENTLY ATTACHED AT THE FACTORY AND ARE NOT DESIGNED FOR FIELD DISASSEMBLY BY OTHERS. CURB FLASHING BY OTHERS MUST TERMINATE BELOW THE BOTTOM EDGE OF THE SKYLIGHT MOUNTING FLANGE. IF IN FACT THE PROJECT FLASHING DESIGN AT THE SKYLIGHT CURB REQUIRES THE FLASHING TO EXTEND UP AND UNDER THE SKYLIGHT MOUNTING FLANGE, PLEASE INDICATE ON THE DRAWING AND EXARC CAN SUPPLY AN APPROPRIATE TYPE CURB / SKYLIGHT ATTACHMENT DETAIL.

## SPECIFICATIONS: MODEL ACIG-9

<b>MODEL:</b> ACIG-9	EXARC DESIGN, FACTORY ASSEMBLED, ALUMINUM FRAME, SELF CURBING COMMERCIAL SKYLIGHT TO FIT OVER SPECIFIED SIZE ROOF OPENING. GLAZING TO BE INSULATED GLASS. ALUMINUM FRAME DESIGN TO HAVE A SLOPED CONDENSATION GUTTER WITH PROVISION TO WEEP MOISTURE TO THE EXTERIOR AND AN INTEGRAL INSULATED CURB WITH INTERIOR FOIL THERMAL LINER. 2-3/4" WIDE MOUNTING FLANGE ALL AROUND THE PERIMETER BASE. OVERALL SKYLIGHT FRAME STANDARD HEIGHT 9" (AVAILABLE FROM 6" TO 9" HEIGHTS OR TAPERED FROM 6" TO 9" ACROSS THE WIDTH FOR INSTALLATIONS ON LEVEL ROOFS) OPTIONAL ALUMINUM LINER AVAILABLE FOR INTERIOR OF CURB.
<b>GLAZING:</b>	TEMPERED OUTER LITE / AIR SPACE / TEMPERED OR LAMINATED INNER LITE ACTUAL GLAZING MAKEUP BASED ON UNIT SIZE AND PROJECT SPECIFICATIONS, COLOR OPTIONS: CLEAR, WHITE TRANSLUCENT, BRONZE, GREY, BLUE OR GREEN TINTED COATING CHOICES: LOW E (SEVERAL PERFORMANCE GRADES), REFLECTIVE COATINGS
<b>FINISH:</b>	MILL FINISH (STANDARD)
<b>ALUMINUM:</b>	EXTRUDED 6063-T5, CURB AND GLAZING FRAME .075", GLAZING RETAINER .065"
<b>FASTENERS:</b>	STAINLESS STEEL. ALL FASTENERS NATURAL FINISH.
<b>GASKET:</b>	EXTRUDED EPDM (BLACK)
<b>SHIPPING:</b>	FACTORY ASSEMBLED UNITS, READY TO MOUNT OVER ROOF OPENING BY OTHERS
<b>INSTALLATION:</b>	BY OTHERS (MOUNTING FASTENERS BY OTHERS)

<b>DESIGN:</b>	DESIGN LOADS PER LOCAL CODES OR PER PROJECT SPECIFICATIONS
----------------	------------------------------------------------------------

<b>SAFETY:</b>	<b>FALL THROUGH AND BREAKAGE</b> - INSULATED GLASS IS NOT INTENDED TO SUPPORT THE WEIGHT OF A PERSON OR ANY OTHER LOAD IMPOSED UPON THE SKYLIGHT. IF THE PROJECT LOCATION INDICATES THAT THE SKYLIGHTS MAY BE SUBJECTED TO INCIDENTAL OR UNINTENDED LIVE LOADS, OR IF THE PROJECT SKYLIGHT SPECIFICATIONS INDICATE THAT OSHA APPROVED FALL THROUGH PROTECTION ARE TO BE INTEGRAL TO THE SKYLIGHT DESIGN, EXARC CAN SUPPLY PROTECTIVE SCREEN COVERS THAT ARE IN COMPLIANCE WITH OSHA FALL THROUGH PROTECTION REQUIREMENTS.
----------------	------------------------------------------------------------------------------------------------------------------------------------------------------------------------------------------------------------------------------------------------------------------------------------------------------------------------------------------------------------------------------------------------------------------------------------------------------------------------------------------------------------------------------

STANDARD SIZES:	UNIT NO.	ROOF OPENING
NOTE: ANY CUSTOM SIZE IS AVAILABLE UP TO 20 SQUARE FEET ROOF OPENING	2424	20" X 20"
	2436	20" X 32"
	2448	20" X 44"
	2472	20" X 68"
	3636	32" X 32"
	3648	32" X 44"

NOTE:  
INSULATED GLASS UNITS MAKE UP FOR SKYLIGHTS WITH ROOF OPENINGS UP TO 9.7 SQUARE FEET:  
3/4" INSULATED GLASS -  
3/16" TEMPERED OUTER LITE / 3/8" AIR SPACE / 3/16" TEMPERED INNER LITE.  
  
FOR LARGER SKYLIGHTS THE GLAZING THICKNESS WILL INCREASE AND THE INNER LITE WILL BE LAMINATED

<b>ORDERING INFORMATION:</b>	INDICATE THE FOLLOWING: ROOF OPENING SIZE - GLAZING SPECIFICATION -	UNIT HEIGHT - QUANTITY -
------------------------------	---------------------------------------------------------------------------	-----------------------------



EXARC SKYLIGHTS, INC.  
3793-B NORTH PEACHTREE RD.  
CHAMBLEE, GA 30341

770-451-4352  
800-247-5934  
FAX: 770-451-4934

WEBSITE: [www.exarcskylights.com](http://www.exarcskylights.com)

EMAIL: [info@exarcskylights.com](mailto:info@exarcskylights.com)

15C

PROJECT:  
CONTRACTOR:

DATE:

PAGE 1 OF 2



EXARC SKYLIGHTS, INC.  
3793-B NORTH PEACHTREE RD.  
CHAMBLEE, GA 30341

770-451-4352  
800-247-5934  
FAX: 770-451-4934

WEBSITE: [www.exarcskylights.com](http://www.exarcskylights.com)

EMAIL: [info@exarcskylights.com](mailto:info@exarcskylights.com)

15S

PROJECT:  
CONTRACTOR:

DATE:

PAGE 2 OF 2



# 16. ACST-9-FTP: Insulated Curb, 9" Frame Height, Double Dome, Fall Through Protection

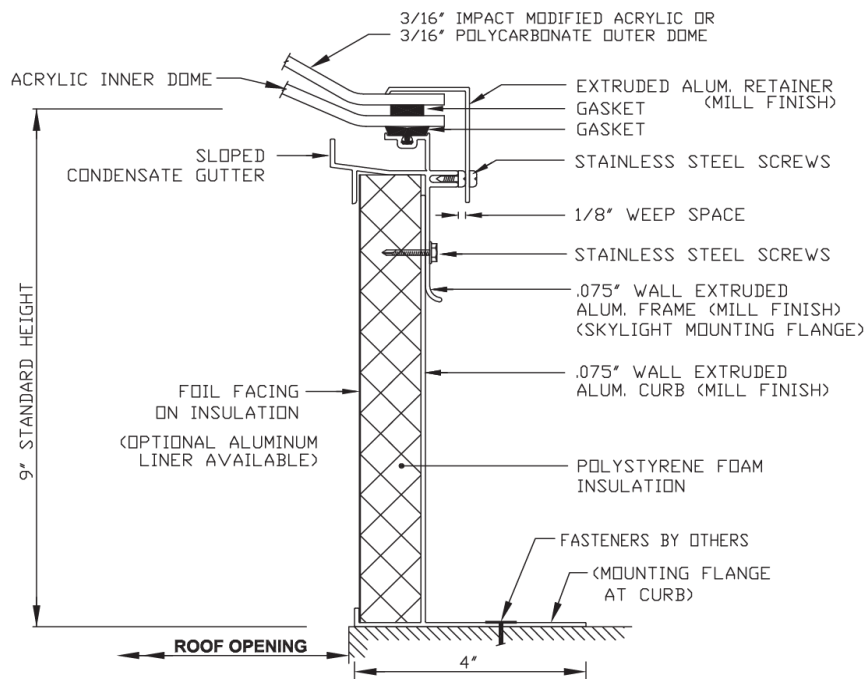

PERIMETER SECTION-SKYLIGHT  
1/2"=1"  
**MODEL ACST-9-FTP**  
INSULATED CURB (DOUBLE DOME)  
WITH FALL THROUGH PROTECTION

EXARC'S MODEL ACST-9, IS A UNIT SKYLIGHT (CMDD) WITH AN INTEGRAL, INSULATED ALUMINUM CURB. THE CURB AND SKYLIGHT ARE PERMANENTLY ATTACHED AT THE FACTORY AND ARE NOT DESIGNED FOR FIELD DISASSEMBLY BY OTHERS. CURB FLASHING BY OTHERS MUST TERMINATE BELOW THE BOTTOM EDGE OF THE SKYLIGHT MOUNTING FLANGE. IF IN FACT THE PROJECT FLASHING DESIGN AT THE SKYLIGHT CURB REQUIRES THE FLASHING TO EXTEND UP AND UNDER THE SKYLIGHT MOUNTING FLANGE, PLEASE INDICATE ON THE DRAWING AND EXARC CAN SUPPLY AN APPROPRIATE TYPE CURB / SKYLIGHT ATTACHMENT DETAIL.

EXARC MODEL CMDD-FTP HAS BEEN LABORATORY TESTED AND FOUND TO BE IN COMPLIANCE WITH (OCCUPATIONAL SAFETY AND HEALTH ADMINISTRATION/ U.S. DEPARTMENT OF LABOR REGULATIONS (STANDARDS-29 CFR)-1910.23 (E)(8) REQUIREMENTS FOR FALL PROTECTION. 10/15/07. UNIT SIZE TESTED 54" X 110"

## SPECIFICATIONS: MODEL ACST-9-FTP

<b>MODEL:</b> ACST-9-FTP	EXARC DESIGN, FACTORY ASSEMBLED, ALUMINUM FRAME, SELF CURBING COMMERCIAL SKYLIGHT WITH FALL THROUGH PROTECTION TO FIT OVER SPECIFIED SIZE ROOF OPENING. GLAZING TO BE THERMOFORMED DOMES. ALUMINUM FRAME DESIGN TO HAVE A SLOPED CONDENSATION GUTTER WITH PROVISION TO WEEP MOISTURE TO THE EXTERIOR AND AN INTEGRAL INSULATED CURB WITH INTERIOR FOIL THERMAL LINER. 2-3/4" WIDE MOUNTING FLANGE ALL AROUND THE PERIMETER BASE. OVERALL SKYLIGHT FRAME STANDARD HEIGHT 9" (AVAILABLE FROM 6" TO 9") OPTIONAL ALUMINUM LINER AVAILABLE FOR INTERIOR OF CURB.
<b>GLAZING:</b>	THERMOFORMED MODIFIED ACRYLIC OR POLYCARBONATE DOME (OUTER LITE) THERMOFORMED ACRYLIC OR POLYCARBONATE DOME (INNER LITE) COLOR OPTIONS: CLEAR/ CLEAR, CLEAR/ WHITE, BRONZE/ CLEAR
<b>FINISH:</b>	MILL FINISH (STANDARD)
<b>ALUMINUM:</b>	EXTRUDED 6063-T5, CURB AND GLAZING FRAME .075", GLAZING RETAINER .065"
<b>FASTENERS:</b>	STAINLESS STEEL. ALL FASTENERS NATURAL FINISH.
<b>GASKET:</b>	EXTRUDED EPDM (BLACK)
<b>SHIPPING:</b>	FACTORY ASSEMBLED UNITS, READY TO MOUNT OVER ROOF OPENING BY OTHERS
<b>INSTALLATION:</b>	BY OTHERS (MOUNTING FASTENERS BY OTHERS)

<b>DESIGN:</b>	DESIGN LOADS PER LOCAL CODES OR PER PROJECT SPECIFICATIONS - GLAZING THICKNESS AND THERMOFORMED HEIGHT OF DOMES OR PYRAMIDS TO CONFORM TO RECOMMENDATIONS IN AAMA 1601-76 AND AAMA 1603-93.
----------------	---------------------------------------------------------------------------------------------------------------------------------------------------------------------------------------------

<b>SAFETY:</b> FTP-FALL THROUGH PROTECTION	OSHA COMPLIANT FALL THROUGH PROTECTION AND BREAKAGE - EXARC MODEL CMDD-FTP HAS BEEN LABORATORY TESTED AND FOUND TO BE IN COMPLIANCE WITH (OCCUPATIONAL SAFETY AND HEALTH ADMINISTRATION / U.S. DEPARTMENT OF LABOR REGULATIONS (STANDARDS-29 CFR)-1910.23 (E)(8) REQUIREMENTS FOR FALL PROTECTION. 10/15/07. UNIT SIZE TESTED 54" X 110"
-----------------------------------------------	------------------------------------------------------------------------------------------------------------------------------------------------------------------------------------------------------------------------------------------------------------------------------------------------------------------------------------------

STANDARD SIZES:	UNIT NO.	ROOF OPENING (RECTANGULAR)	UNIT NO.	ROOF OPENING (SQUARE)
	3672	32" X 68"	4848	44" X 44"
	3696	32" X 92"	5252	48" X 48"
<b>NOTE:</b> ANY CUSTOM SIZE IS AVAILABLE UP TO 50" X 106" ROOF OPENING	4872	44" X 68"		
	4896	44" X 92"		
	5276	48" X 72"		
	5296	48" X 92"		
	52102	48" X 98"		

<b>ORDERING INFORMATION:</b>	INDICATE THE FOLLOWING: ROOF OPENING SIZE - GLAZING MATERIAL REQUIRED -	GLAZING COLOR- QUANTITY-
------------------------------	-------------------------------------------------------------------------------	-----------------------------



EXARC SKYLIGHTS, INC.  
3793-B NORTH PEACHTREE RD.  
CHAMBLEE, GA 30341

WEBSITE: [www.exarcskylights.com](http://www.exarcskylights.com)

770-451-4352  
800-247-5934  
FAX: 770-451-4934

EMAIL: [info@exarcskylights.com](mailto:info@exarcskylights.com)

16C

PROJECT:  
CONTRACTOR:

DATE:

PAGE 1 OF 2



EXARC SKYLIGHTS, INC.  
3793-B NORTH PEACHTREE RD.  
CHAMBLEE, GA 30341

WEBSITE: [www.exarcskylights.com](http://www.exarcskylights.com)

770-451-4352  
800-247-5934  
FAX: 770-451-4934

EMAIL: [info@exarcskylights.com](mailto:info@exarcskylights.com)

16S

PROJECT:  
CONTRACTOR:

DATE:

PAGE 2 OF 2

# 17. ACST-9-TB-FTP: Insulated Curb, 9" Frame Height, Double Dome, Fall Through Protection, Thermal Break Curb Frame

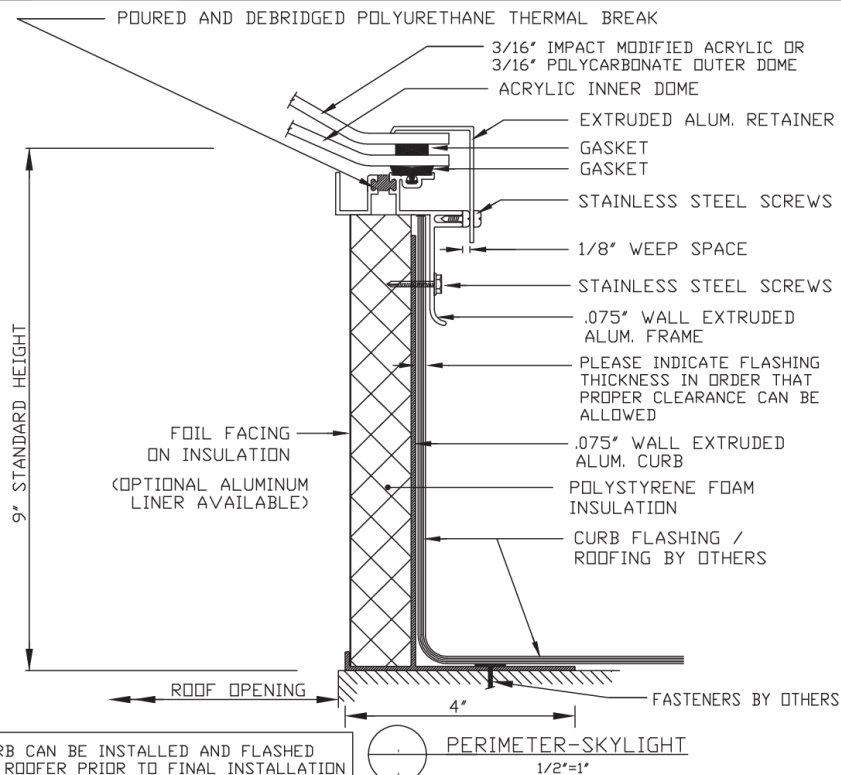

CURB CAN BE INSTALLED AND FLASHED BY ROOFER PRIOR TO FINAL INSTALLATION OF SKYLIGHT ONTO CURB. SKYLIGHTS TO BE SHIPPED ATTACHED TO CURBS WITH MINIMAL FASTENERS FOR EASY REMOVAL.

EXARC MODEL CMDD-FTP HAS BEEN LABORATORY TESTED AND FOUND TO BE IN COMPLIANCE WITH OCCUPATIONAL SAFETY AND HEALTH ADMINISTRATION / U.S. DEPARTMENT OF LABOR REGULATIONS (STANDARDS-29 CFR)-1910.23 (E)(8)) REQUIREMENTS FOR FALL PROTECTION. 10/15/07. UNIT SIZE TESTED 54" X 110"

## MODEL ACST-9-TB-FTP INSULATED CURB (DOUBLE DOME) WITH FALL THROUGH PROTECTION AND THERMAL BREAK GLAZING FRAME



EXARC SKYLIGHTS, INC.  
3793-B NORTH PEACHTREE RD.  
CHAMBLEE, GA 30341

WEBSITE: [www.exarcskylights.com](http://www.exarcskylights.com)

770-451-4352  
800-247-5934  
FAX: 770-451-4934

EMAIL: [info@exarcskylights.com](mailto:info@exarcskylights.com)

17C

PROJECT:  
CONTRACTOR:

DATE:

PAGE 1 OF 2

## SPECIFICATIONS: MODEL ACST-9-TB-FTP

<b>MODEL:</b> ACST-9-TB-FTP	EXARC DESIGN, FACTORY ASSEMBLED, ALUMINUM FRAME, SELF CURBING COMMERCIAL SKYLIGHT WITH FALL THROUGH PROTECTION TO FIT OVER SPECIFIED SIZE ROOF OPENING. GLAZING TO BE THERMOFORMED DOMES. ALUMINUM FRAME DESIGN WITH THERMAL BREAK AND PROVISION TO WEEP MOISTURE TO THE EXTERIOR AND AN INTEGRAL INSULATED CURB WITH INTERIOR FOIL THERMAL LINER. 2-3/4" WIDE MOUNTING FLANGE ALL AROUND THE PERIMETER BASE. OVERALL SKYLIGHT FRAME STANDARD HEIGHT 9" (AVAILABLE FROM 6" TO 9") OPTIONAL ALUMINUM LINER AVAILABLE FOR INTERIOR OF CURB.
<b>GLAZING:</b>	THERMOFORMED MODIFIED ACRYLIC OR POLYCARBONATE DOME (OUTER LITE) THERMOFORMED ACRYLIC OR POLYCARBONATE DOME (INNER LITE) COLOR OPTIONS: CLEAR/ CLEAR, CLEAR/ WHITE, BRONZE/ CLEAR
<b>FINISH:</b>	MILL FINISH (STANDARD)
<b>ALUMINUM:</b>	EXTRUDED 6063-T5, CURB AND GLAZING FRAME .075", GLAZING RETAINER .065"
<b>FASTENERS:</b>	STAINLESS STEEL. ALL FASTENERS NATURAL FINISH.
<b>GASKET:</b>	EXTRUDED EPDM (BLACK)
<b>SHIPPING:</b>	FACTORY ASSEMBLED UNITS, READY TO MOUNT OVER ROOF OPENING BY OTHERS
<b>INSTALLATION:</b>	BY OTHERS (MOUNTING FASTENERS BY OTHERS)

**DESIGN:** DESIGN LOADS PER LOCAL CODES OR PER PROJECT SPECIFICATIONS - GLAZING THICKNESS AND THERMOFORMED HEIGHT OF DOMES OR PYRAMIDS TO CONFORM TO RECOMMENDATIONS IN AAMA 1601-76 AND AAMA 1603-93.

**SAFETY:**  
**FTP-FALL THROUGH PROTECTION** OSHA COMPLIANT FALL THROUGH PROTECTION AND BREAKAGE - EXARC MODEL CMDD-FTP HAS BEEN LABORATORY TESTED AND FOUND TO BE IN COMPLIANCE WITH (OCCUPATIONAL SAFETY AND HEALTH ADMINISTRATION / U.S. DEPARTMENT OF LABOR REGULATIONS (STANDARDS-29 CFR)-1910.23 (E)(8)) REQUIREMENTS FOR FALL PROTECTION. 10/15/07. UNIT SIZE TESTED 54" X 110"

STANDARD SIZES:	UNIT NO.	ROOF OPENING (RECTANGULAR)	UNIT NO.	ROOF OPENING (SQUARE)
	3672	32" X 68"	4848	44" X 44"
	3696	32" X 92"	5252	48" X 48"
<b>NOTE:</b> ANY CUSTOM SIZE IS AVAILABLE UP TO 50" X 106" ROOF OPENING	4872	44" X 68"		
	4896	44" X 92"		
	5276	48" X 72"		
	5296	48" X 92"		
	52102	48" X 98"		

**ORDERING INFORMATION:** INDICATE THE FOLLOWING:  
ROOF OPENING SIZE -  
GLAZING MATERIAL REQUIRED -

GLAZING COLOR  
QUANTITY-



EXARC SKYLIGHTS, INC.  
3793-B NORTH PEACHTREE RD.  
CHAMBLEE, GA 30341

WEBSITE: [www.exarcskylights.com](http://www.exarcskylights.com)

770-451-4352  
800-247-5934  
FAX: 770-451-4934

EMAIL: [info@exarcskylights.com](mailto:info@exarcskylights.com)

17S

PROJECT:  
CONTRACTOR:

DATE:

PAGE 2 OF 2

# 18. ACST-9-PRZ-FTP: Insulated Curb, 9" Frame Height, Double Prismatic Polycarbonate Dome, Fall Through Protection

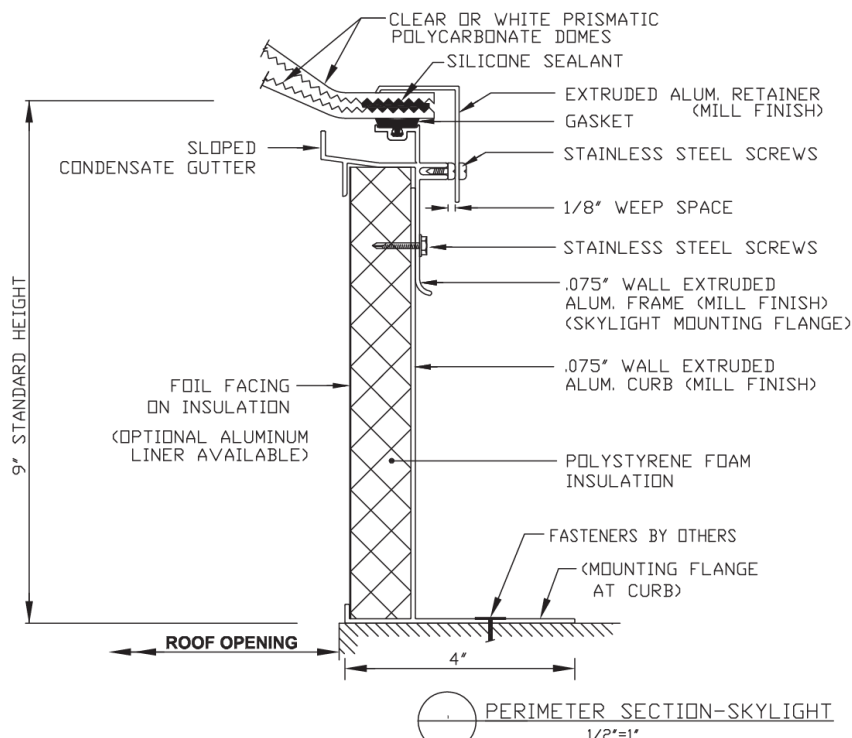

## MODEL ACST-9-PRZ-FTP DOUBLE PRISMATIC POLYCARBONATE DOME SKYLIGHT WITH INSULATED CURB AND FALL THROUGH PROTECTION

EXARC'S MODEL ACST-9, IS A UNIT SKYLIGHT (CMDD) WITH AN INTEGRAL INSULATED ALUMINUM CURB. THE CURB AND SKYLIGHT ARE PERMANENTLY ATTACHED AT THE FACTORY AND ARE NOT DESIGNED FOR FIELD DISASSEMBLY BY OTHERS. CURB FLASHING BY OTHERS MUST TERMINATE BELOW THE BOTTOM EDGE OF THE SKYLIGHT MOUNTING FLANGE. IF IN FACT THE PROJECT FLASHING DESIGN AT THE SKYLIGHT CURB REQUIRES THE FLASHING TO EXTEND UP AND UNDER THE SKYLIGHT MOUNTING FLANGE, PLEASE INDICATE ON THE DRAWING AND EXARC CAN SUPPLY AN APPROPRIATE TYPE CURB / SKYLIGHT ATTACHMENT DETAIL.

EXARC MODEL CMDD-PRZ-FTP HAS BEEN LABORATORY TESTED AND FOUND TO BE IN COMPLIANCE WITH (OCCUPATIONAL SAFETY AND HEALTH ADMINISTRATION/ U.S. DEPARTMENT OF LABOR REGULATIONS (STANDARDS-29 CFR)-1910.23 (E)(8)) REQUIREMENTS FOR FALL PROTECTION. 10/15/07. UNIT SIZE TESTED 48" X 96"

## SPECIFICATIONS: MODEL ACST-9-PRZ-FTP

MODEL: ACST-9-PRZ-FTP	EXARC DESIGN, FACTORY ASSEMBLED, ALUMINUM FRAME, SELF CURBING COMMERCIAL SKYLIGHT WITH FALL THROUGH PROTECTION TO FIT OVER SPECIFIED SIZE ROOF OPENING. GLAZING TO BE THERMOFORMED DOMES. ALUMINUM FRAME DESIGN TO HAVE A SLOPED CONDENSATION GUTTER WITH PROVISION TO WEEP MOISTURE TO THE EXTERIOR AND AN INTEGRAL INSULATED CURB WITH INTERIOR FOIL THERMAL LINER. 2-3/4" WIDE MOUNTING FLANGE ALL AROUND THE PERIMETER BASE. OVERALL SKYLIGHT FRAME STANDARD HEIGHT 9" (AVAILABLE FROM 6" TO 9") OPTIONAL ALUMINUM LINER AVAILABLE FOR INTERIOR OF CURB.
GLAZING:	THERMOFORMED PRISMATIC POLYCARBONATE DOME (OUTER LITE) THERMOFORMED PRISMATIC POLYCARBONATE DOME (INNER LITE) COLOR OPTIONS: CLEAR/ CLEAR, CLEAR/ WHITE
FINISH:	MILL FINISH (STANDARD)
ALUMINUM:	EXTRUDED 6063-T5, CURB AND GLAZING FRAME .075", GLAZING RETAINER .065"
FASTENERS:	STAINLESS STEEL. ALL FASTENERS NATURAL FINISH.
GASKET:	EXTRUDED EPDM (BLACK)
SHIPPING:	FACTORY ASSEMBLED UNITS, READY TO MOUNT OVER ROOF OPENING BY OTHERS
INSTALLATION:	BY OTHERS (MOUNTING FASTENERS BY OTHERS)

DESIGN:	DESIGN LOADS PER LOCAL CODES OR PER PROJECT SPECIFICATIONS
---------	------------------------------------------------------------

SAFETY: FTP-FALL THROUGH PROTECTION	OSHA COMPLIANT FALL THROUGH PROTECTION AND BREAKAGE - EXARC MODEL CMDD-PRZ-FTP HAS BEEN LABORATORY TESTED AND FOUND TO BE IN COMPLIANCE WITH (OCCUPATIONAL SAFETY AND HEALTH ADMINISTRATION / U.S. DEPARTMENT OF LABOR REGULATIONS (STANDARDS-29 CFR)-1910.23 (E)(8)) REQUIREMENTS FOR FALL PROTECTION. UNIT SIZE TESTED 48" X 96"
----------------------------------------------	---------------------------------------------------------------------------------------------------------------------------------------------------------------------------------------------------------------------------------------------------------------------------------------------------------------------------------------

STANDARD SIZES:	UNIT NO.	ROOF OPENING (RECTANGULAR)	NOTE: EXARC MODEL CMDD-PRZ-FTP HAS BEEN LABORATORY TESTED AND FOUND TO BE WITHIN THE RECOMMENDED PERFORMANCE VALUES FOR THE FOLLOWING TESTS: - AIR, WATER AND STRUCTURAL TESTING (AAMA/WDMA/CSA101/LS2/A440) USING ASTM E 283, ASTM E 330, AND ASTM E 331 TEST METHODS  -ASTM F588 FORCED ENTRY RESISTANCE  -FM 4431 - SIMULATED HAIL IMPACT RESISTANCE TEST USING 2" FREEZER ICE BALLS FIRED AT THE SAMPLE SKYLIGHT
	4848	44" X 44"	
	4872	44" X 68"	
	4896	44" X 92"	

ORDERING INFORMATION:	INDICATE THE FOLLOWING: ROOF OPENING SIZE - GLAZING MATERIAL REQUIRED -	GLAZING COLOR  QUANTITY-
--------------------------	-------------------------------------------------------------------------------	--------------------------------



EXARC SKYLIGHTS, INC.  
3793-B NORTH PEACHTREE RD.  
CHAMBLEE, GA 30341

WEBSITE: [www.exarcskylights.com](http://www.exarcskylights.com)

770-451-4352  
800-247-5934  
FAX: 770-451-4934

EMAIL: [info@exarcskylights.com](mailto:info@exarcskylights.com)

18C

PROJECT: \_\_\_\_\_ DATE: \_\_\_\_\_  
CONTRACTOR: \_\_\_\_\_



EXARC SKYLIGHTS, INC.  
3793-B NORTH PEACHTREE RD.  
CHAMBLEE, GA 30341

WEBSITE: [www.exarcskylights.com](http://www.exarcskylights.com)

770-451-4352  
800-247-5934  
FAX: 770-451-4934

EMAIL: [info@exarcskylights.com](mailto:info@exarcskylights.com)

18S

PROJECT: \_\_\_\_\_ DATE: \_\_\_\_\_  
CONTRACTOR: \_\_\_\_\_

# 19. ACST-9-TB-PRZ-FTP: Insulated Curb, 9" Frame Height Curb Frame, Double Prismatic Polycarbonate Dome, Fall Through Protection

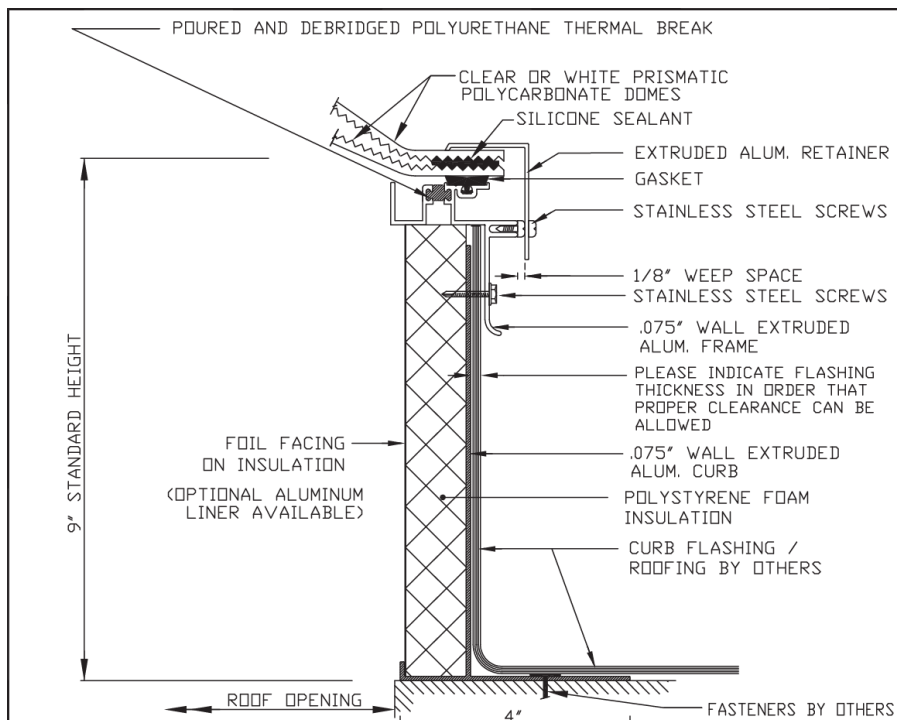

CURB CAN BE INSTALLED AND FLASHED BY ROOFER PRIOR TO FINAL INSTALLATION OF SKYLIGHT ONTO CURB. SKYLIGHTS TO BE SHIPPED ATTACHED TO CURBS WITH MINIMAL FASTENERS FOR EASY REMOVAL.

EXARC MODEL CMDD-PRZ-FTP WAS LABORATORY TESTED AND FOUND TO BE IN COMPLIANCE WITH OCCUPATIONAL SAFETY AND HEALTH ADMINISTRATION / U.S. DEPARTMENT OF LABOR REGULATIONS (STANDARDS-29 CFR)-1910.23 (E)(8) REQUIREMENTS FOR FALL PROTECTION. UNIT SIZE TESTED 48" X 96"

PERIMETER-SKYLIGHT  
1/2"=1"

## MODEL ACST-9-TB-PRZ-FTP

DOUBLE PRISMATIC POLYCARBONATE DOME SKYLIGHT WITH THERMAL BREAK FRAME, INSULATED CURB AND FALL THROUGH PROTECTION



EXARC SKYLIGHTS, INC.  
3793-B NORTH PEACHTREE RD.  
CHAMBLEE, GA 30341

WEBSITE: [www.exarcskylights.com](http://www.exarcskylights.com)

770-451-4352  
800-247-5934  
FAX: 770-451-4934

EMAIL: [info@exarcskylights.com](mailto:info@exarcskylights.com)

79C

PROJECT:  
CONTRACTOR:

DATE:

PAGE 1 OF 2

## SPECIFICATIONS: MODEL ACST-9-TB-PRZ-FTP

MODEL: ACST-9-TB-PRZ-FTP	EXARC DESIGN, FACTORY ASSEMBLED, ALUMINUM FRAME, SELF CURBING COMMERCIAL SKYLIGHT WITH FALL THROUGH PROTECTION TO FIT OVER SPECIFIED SIZE ROOF OPENING. GLAZING TO BE THERMOFORMED DOMES. ALUMINUM FRAME DESIGN WITH THERMAL BREAK AND PROVISION TO WEEP MOISTURE TO THE EXTERIOR AND INSULATED CURB WITH INTERIOR FOIL THERMAL LINER. 2-3/4" WIDE MOUNTING FLANGE ALL AROUND THE PERIMETER BASE. OVERALL SKYLIGHT FRAME STANDARD HEIGHT 9" (AVAILABLE FROM 6" TO 9") OPTIONAL ALUMINUM LINER AVAILABLE FOR INTERIOR OF CURB.
GLAZING:	THERMOFORMED PRISMATIC POLYCARBONATE DOME (OUTER LITE) THERMOFORMED PRISMATIC POLYCARBONATE DOME (INNER LITE) COLOR OPTIONS: CLEAR/ CLEAR, CLEAR/ WHITE
FINISH:	MILL FINISH (STANDARD)
ALUMINUM:	EXTRUDED 6063-T5, CURB AND GLAZING FRAME .075", GLAZING RETAINER .065"
FASTENERS:	STAINLESS STEEL. ALL FASTENERS NATURAL FINISH.
GASKET:	EXTRUDED EPDM (BLACK)
SHIPPING:	FACTORY ASSEMBLED UNITS, READY TO MOUNT OVER ROOF OPENING BY OTHERS
INSTALLATION:	BY OTHERS (MOUNTING FASTENERS BY OTHERS)

DESIGN:	DESIGN LOADS PER LOCAL CODES OR PER PROJECT SPECIFICATIONS
---------	------------------------------------------------------------

SAFETY: FTP-FALL THROUGH PROTECTION	OSHA COMPLIANT FALL THROUGH PROTECTION AND BREAKAGE - EXARC MODEL CMDD-PRZ-FTP HAS BEEN LABORATORY TESTED AND FOUND TO BE IN COMPLIANCE WITH (OCCUPATIONAL SAFETY AND HEALTH ADMINISTRATION / U.S. DEPARTMENT OF LABOR REGULATIONS (STANDARDS-29 CFR)-1910.23 (E)(8) REQUIREMENTS FOR FALL PROTECTION. UNIT SIZE TESTED 48" X 96"
----------------------------------------	-----------------------------------------------------------------------------------------------------------------------------------------------------------------------------------------------------------------------------------------------------------------------------------------------------------------------------------

STANDARD SIZES:	UNIT NO.	ROOF OPENING (RECTANGULAR)
	4848	44" X 44"
	4872	44" X 68"
	4896	44" X 92"

NOTE:  
EXARC MODEL CMDD-PRZ-FTP HAS BEEN LABORATORY TESTED AND FOUND TO BE WITHIN THE RECOMMENDED PERFORMANCE VALUES FOR THE FOLLOWING TESTS:  
- AIR, WATER AND STRUCTURAL TESTING (AAMA/WDMA/CSA101/LS2/A440) USING ASTM E 283, ASTM E 330, AND ASTM E 331 TEST METHODS  
-ASTM F588 FORCED ENTRY RESISTANCE  
-FM 4431 - SIMULATED HAIL IMPACT RESISTANCE TEST USING 2" FREEZER ICE BALLS FIRED AT THE SAMPLE SKYLIGHT

ORDERING INFORMATION:	INDICATE THE FOLLOWING: ROOF OPENING SIZE - GLAZING MATERIAL REQUIRED -	GLAZING COLOR QUANTITY-
-----------------------	-------------------------------------------------------------------------------	----------------------------



EXARC SKYLIGHTS, INC.  
3793-B NORTH PEACHTREE RD.  
CHAMBLEE, GA 30341

WEBSITE: [www.exarcskylights.com](http://www.exarcskylights.com)

770-451-4352  
800-247-5934  
FAX: 770-451-4934

EMAIL: [info@exarcskylights.com](mailto:info@exarcskylights.com)

79S

PROJECT:  
CONTRACTOR:

DATE:

PAGE 2 OF 2



20. **ICW-CMDD:** 9" High Insulated Curb with Wood Nailer and Aluminum Liner & Separate Curb Mount, Double Dome Skylight

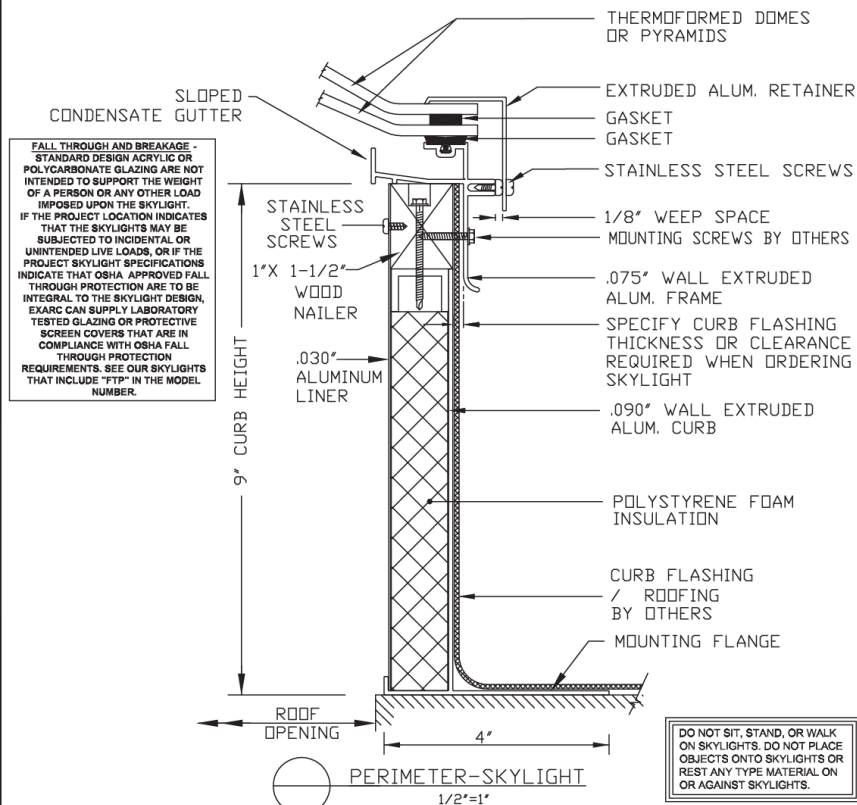

## MODEL ICW-CMDD

INSULATED CURB WITH WOOD NAILER AND ALUMINUM LINER  
& SEPARATE CURB MOUNT DOUBLE DOME SKYLIGHT



**EXARC SKYLIGHTS, INC.**  
**3793-B NORTH PEACHTREE RD.**  
**CHAMBLEE, GA 30341**

**WEBSITE:** [www.exarcskylights.com](http://www.exarcskylights.com)

**770-451-4352**  
**800-247-5934**  
**FAX: 770-451-4934**

**EMAIL:**[info@exarcskylights.com](mailto:info@exarcskylights.com)

**20C**

## SPECIFICATIONS: MODEL CMDD-TB-PRZ-FTP

<b>MODEL:</b> <b>CMDD-PRZ-FTP</b>	EXARC DESIGN, FACTORY ASSEMBLED, THERMAL BREAK ALUMINUM FRAME, CURB MOUNT SKYLIGHT WITH FALL THROUGH PROTECTION TO MOUNT ONTO SLOPED OR LEVEL FLASHED CURBS BY OTHERS. GLAZING TO BE THERMOFORMED, PRISMATIC POLYCARBONATE DOMES. ALUMINUM FRAME DESIGN WITH MITERED AND WELDED CORNERS TO HAVE PROVISION TO DRAIN ALL MOISTURE TO THE EXTERIOR.
<b>GLAZING:</b>	THERMOFORMED PRISMATIC POLYCARBONATE DOME (OUTER LITE) THERMOFORMED PRISMATIC POLYCARBONATE DOME (INNER LITE) COLOR OPTIONS: CLEAR/ CLEAR, CLEAR/ WHITE
<b>FINISH:</b>	MILL FINISH (STANDARD)
<b>ALUMINUM:</b>	EXTRUDED 6063-T5, GLAZING FRAME .075", GLAZING RETAINER .065"
<b>FASTENERS:</b>	STAINLESS STEEL AT GLAZING CAPS. ALL FASTENERS NATURAL FINISH.
<b>GASKET:</b>	EXTRUDED EPDM (BLACK)
<b>SHIPPING:</b>	FACTORY ASSEMBLED UNITS
<b>INSTALLATION:</b>	BY OTHERS

<b>DESIGN:</b>	<b>DESIGN LOADS PER LOCAL CODES OR PER PROJECT SPECIFICATIONS</b>
----------------	-------------------------------------------------------------------

SAFETY: FTP-FALL THROUGH PROTECTION	OSHA COMPLIANT FALL THROUGH PROTECTION AND BREAKAGE - EXARC MODEL CMDD-PRZ-FTP HAS BEEN LABORATORY TESTED AND FOUND TO BE IN COMPLIANCE WITH (OCCUPATIONAL SAFETY AND HEALTH ADMINISTRATION / U.S. DEPARTMENT OF LABOR REGULATIONS (STANDARDS-29 CFR)-1910.23 (E)(8)) REQUIREMENTS FOR FALL PROTECTION. UNIT SIZE TESTED 48" X 96"
----------------------------------------------	------------------------------------------------------------------------------------------------------------------------------------------------------------------------------------------------------------------------------------------------------------------------------------------------------------------------------------

STANDARD SIZES:	UNIT NO.	OUT SIDE CURB DIMENSIONS	<p>NOTE: EXARC MODEL CMDD-PRZ-FTP HAS BEEN LABORATORY TESTED AND FOUND TO BE WITHIN THE RECOMMENDED PERFORMANCE VALUES FOR THE FOLLOWING TESTS:</p> <p>- AIR, WATER AND STRUCTURAL TESTING (AAMA/WDMA/CSA101/LS.2/A440) USING ASTM E 283, ASTM E 330, AND ASTM E 331 TEST METHODS</p> <p>-ASTM F588 FORCED ENTRY RESISTANCE</p>
	4848	47" X 47"	
	4872	44" X 71"	
	4896	47" X 95"	

**NOTE:**  
EXARC MODEL CMDD-PRZ-FTP HAS BEEN LABORATORY  
TESTED AND FOUND TO BE WITHIN THE  
RECOMMENDED PERFORMANCE VALUES FOR  
THE FOLLOWING TESTS:

**- AIR, WATER AND STRUCTURAL TESTING  
(AAMA/WDMA/CSA101/LS2/A440) USING ASTM E 283,  
ASTM E 330, AND ASTM E 331 TEST METHODS**

-ASTM F588 FORCED ENTRY RESISTANCE

**-FM 4431 - SIMULATED HAIL IMPACT RESISTANCE TEST USING 2" FREEZER ICE BALLS FIRED AT THE SAMPLE SKYLIGHT**

ORDERING INFORMATION:	INDICATE THE FOLLOWING: OUTSIDE CURB DIMENSIONS	GLAZING COLOR-  QUANTITY
-----------------------	----------------------------------------------------	--------------------------------



**EXARC SKYLIGHTS, INC.**  
3793-B NORTH PEACHTREE RD.  
CHAMBLEE, GA 30341

**WEBSITE:** [www.exarcskylights.com](http://www.exarcskylights.com)

770-451-4352  
800-247-5934  
X: 770-451-4934

**EMAIL:**[info@exarcskylights.com](mailto:info@exarcskylights.com)

95

PROJECT:  
CONTRACTOR:

DATE:

PAGE 2 OF 2



# 21. ICW-CMDD-FTP: 9" High Insulated Curb with Wood Nailer and Aluminum Liner & Separate Curb Mount Double Dome Skylight with OSHA Compliant Fall Through Protection

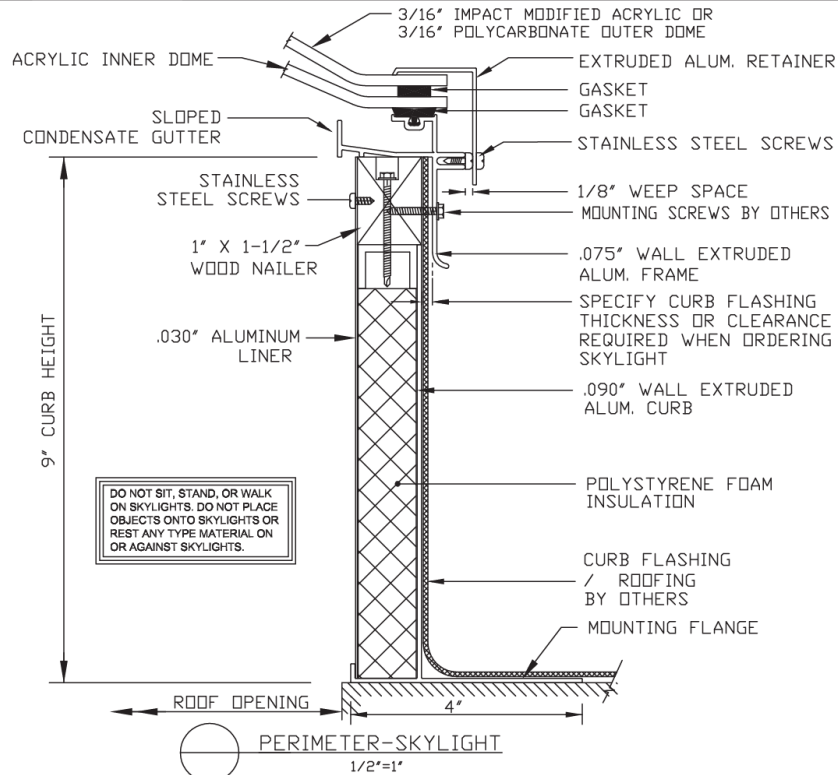

## MODEL ICW-CMDD-FTP

INSULATED CURB WITH WOOD NAILER AND ALUMINUM LINER  
& SEPARATE CURB MOUNT DOUBLE DOME SKYLIGHT  
WITH OSHA COMPLIANT FALL THROUGH PROTECTION

CURB TO BE INSTALLED AND FLASHED  
BY ROOFER PRIOR TO FINAL INSTALLATION  
OF SKYLIGHT ONTO CURB. SKYLIGHTS TO  
BE SHIPPED SEPARATELY FROM CURBS

EXARC MODEL CMDD-FTP HAS BEEN LABORATORY TESTED AND FOUND  
TO BE IN COMPLIANCE WITH (OCCUPATIONAL SAFETY AND HEALTH  
ADMINISTRATION/ U.S. DEPARTMENT OF LABOR REGULATIONS  
(STANDARDS-29 CFR)-1910.23 (E)(8) REQUIREMENTS FOR FALL  
PROTECTION. 10/15/07. UNIT SIZE TESTED 54" X 110"



EXARC SKYLIGHTS, INC.  
3793-B NORTH PEACHTREE RD.  
CHAMBLEE, GA 30341

770-451-4352  
800-247-5934  
FAX: 770-451-4934

WEBSITE: [www.exarcskylights.com](http://www.exarcskylights.com)

EMAIL: [info@exarcskylights.com](mailto:info@exarcskylights.com)

21C

PROJECT:  
CONTRACTOR:

DATE:

PAGE 1 OF 2

## SPECIFICATIONS: MODEL ICW-CMDD-FTP

MODEL: ICW-CMDD-FTP	EXARC DESIGN, FACTORY ASSEMBLED, ALUMINUM FRAME, CURB MOUNT SKYLIGHT WITH THERMOFORMED, 25% RISE, MODIFIED ACRYLIC OR POLYCARBONATE DOMES, MOUNTED ONTO A 9" HIGH CURB BY EXARC. (OSHA COMPLIANT FALL THROUGH PROTECTION)
GLAZING:	THERMOFORMED MODIFIED ACRYLIC OR POLYCARBONATE DOME (OUTER LITE) THERMOFORMED ACRYLIC OR POLYCARBONATE DOME (INNER LITE) COLOR OPTIONS: CLEAR/ CLEAR, CLEAR/ WHITE, BRONZE/ CLEAR
FINISH:	MILL FINISH (STANDARD)
ALUMINUM:	EXTRUDED 6063-T5, GLAZING FRAME .075", GLAZING RETAINER .065"
FASTENERS:	STAINLESS STEEL AT GLAZING CAPS. ZINC PLATED AT STRUCTURAL CONNECTIONS. ALL FASTENERS NATURAL FINISH.
GASKET:	EPDM (BLACK)
SHIPPING:	FACTORY ASSEMBLED UNITS, READY TO MOUNT ONTO MODEL ICW CURB BY EXARC.
INSTALLATION:	BY OTHERS
MODEL: ICW INSULATED CURBS WITH WOOD NAILER	EXARC DESIGN, FACTORY ASSEMBLED, 1-1/8" WIDE DOUBLE WALL, 9" HIGH, INSULATED ALUMINUM CURBS WITH WOOD NAILER. 2-3/4" WIDE HORIZONTAL MOUNTING FLANGE ALL AROUND THE PERIMETER BASE OF THE CURB FOR FASTENING TO THE ROOF DECK. CURBS TO MOUNT OVER ROOF OPENINGS OF BY OTHERS. TOP OF CURBS TO BE FLAT TO RECEIVE EXARC SKYLIGHTS MODEL CMDD. OUTER CURB WALL CORNERS TO BE WELDED WATER TIGHT. CURBS TO BE SHIPPED SEPARATE FROM SKYLIGHTS IN ORDER THAT CURBS CAN BE INSTALLED AND FLASHED BY OTHERS PRIOR TO SKYLIGHT ATTACHMENT TO CURBS.
ALUMINUM:	OUTER CURB WALL - .075" THICK EXTRUDED ALUMINUM (6063) INNER CURB LINER - .030" THICK FORMED ALUMINUM (3003)
FINISH:	MILL FINISH ALUMINUM
INSULATION:	EXPANDED POLYSTYRENE FOAM
FASTENERS:	MOUNTING FASTENERS TO ROOF DECK BY OTHERS
SHIPPING:	FACTORY ASSEMBLED, READY TO MOUNT OVER ROOF OPENING
INSTALLATION:	BY OTHERS

STANDARD SIZES:	UNIT NO.	ROOF OPENING (RECTANGULAR)	UNIT NO.	ROOF OPENING (SQUARE)
NOTE: ANY CUSTOM SIZE IS AVAILABLE UP TO 50" X 106" ROOF OPENING	3672	32" X 68"	4848	44" X 44"
	3696	32" X 92"	5252	48" X 48"
	4872	44" X 68"		
	4896	44" X 92"		
	5276	48" X 72"		
	5296	48" X 92"	52102	48" X 98"

EXARC MODEL CMDD-FTP HAS  
BEEN LABORATORY TESTED AND  
FOUND TO BE IN COMPLIANCE WITH  
(OCCUPATIONAL SAFETY AND  
HEALTH ADMINISTRATION/ U.S.  
DEPARTMENT OF LABOR  
REGULATIONS (STANDARDS-29  
CFR)-1910.23 (E)(8) REQUIREMENTS  
FOR FALL PROTECTION. 10/15/07.  
UNIT SIZE TESTED 54" X 110"

ORDERING  
INFORMATION:

INDICATE THE FOLLOWING:  
ROOF OPENING SIZE -  
THICKNESS OF ROOFING  
MATERIAL AT CURB FLASHING -

GLAZING MATERIAL REQUIRED -  
GLAZING TINT -  
QUANTITY-



EXARC SKYLIGHTS, INC.  
3793-B NORTH PEACHTREE RD.  
CHAMBLEE, GA 30341

WEBSITE: [www.exarcskylights.com](http://www.exarcskylights.com)

770-451-4352  
800-247-5934  
FAX: 770-451-4934

EMAIL: [info@exarcskylights.com](mailto:info@exarcskylights.com)

21S

PROJECT:  
CONTRACTOR:

DATE:

PAGE 2 OF 2

# 22. ICW-CMDD-PRZ-FTP: 9" High Insulated Curb with Wood Nailer and Aluminum Liner & Separate Curb Mount Double Prismatic Dome with OSHA Compliant Fall Through Protection

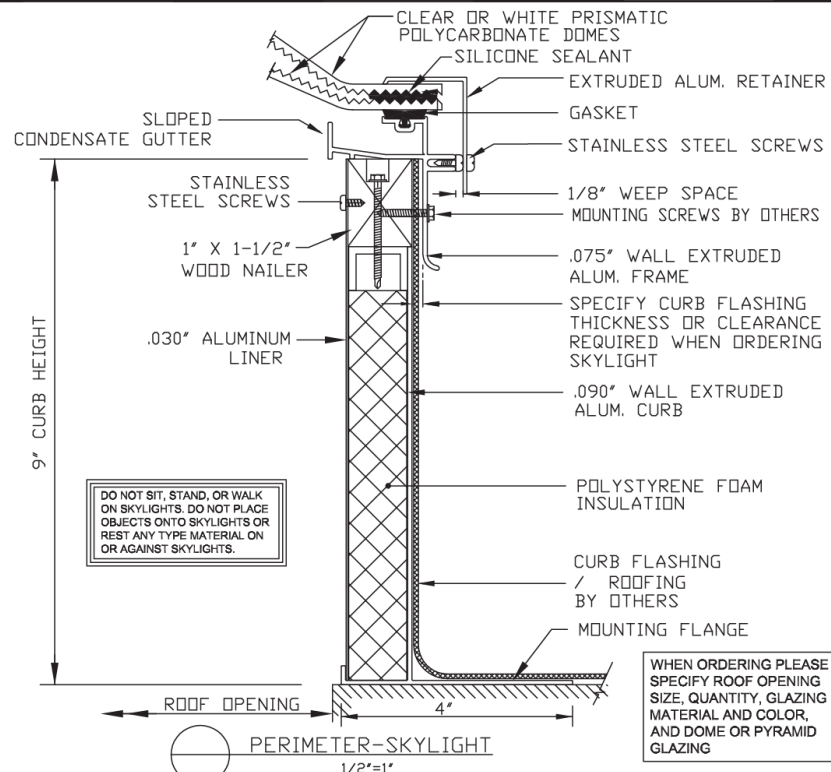

## MODEL ICW-CMDD-PRZ-FTP

INSULATED CURB WITH WOOD NAILER AND ALUMINUM LINER  
& SEPARATE CURB MOUNT DOUBLE PRISMATIC DOME SKYLIGHT  
WITH OSHA COMPLIANT FALL THROUGH PROTECTION

CURB TO BE INSTALLED AND FLASHED  
BY ROOFER PRIOR TO FINAL INSTALLATION  
OF SKYLIGHT ONTO CURB. SKYLIGHTS TO  
BE SHIPPED SEPARATELY FROM CURBS

EXARC MODEL CMDD-PRZ-FTP HAS BEEN LABORATORY TESTED AND  
FOUND TO BE IN COMPLIANCE WITH (OCCUPATIONAL SAFETY AND  
HEALTH ADMINISTRATION/ U.S. DEPARTMENT OF LABOR REGULATIONS  
(STANDARDS-29 CFR)-1910.23 (E)(8)) REQUIREMENTS FOR FALL  
PROTECTION. UNIT SIZE TESTED 48" X 96"



EXARC SKYLIGHTS, INC.  
3793-B NORTH PEACHTREE RD.  
CHAMBLEE, GA 30341

WEBSITE: [www.exarcskylights.com](http://www.exarcskylights.com)

770-451-4352

800-247-5934

FAX: 770-451-4934

EMAIL: [info@exarcskylights.com](mailto:info@exarcskylights.com)

22C

PROJECT:  
CONTRACTOR:

DATE:

PAGE 1 OF 2

## SPECIFICATIONS: MODEL ICW-CMDD-PRZ-FTP

MODEL: ICW-CMDD- PRZ-FTP	EXARC DESIGN, FACTORY ASSEMBLED, ALUMINUM FRAME, CURB MOUNT SKYLIGHT WITH THERMOFORMED, PRISMATIC POLYCARBONATE DOMES, MOUNTED ONTO A 9" HIGH CURB BY EXARC. (OSHA COMPLIANT FALL THROUGH PROTECTION)
GLAZING:	THERMOFORMED PRISMATIC POLYCARBONATE DOME (OUTER LITE) THERMOFORMED PRISMATIC POLYCARBONATE DOME (INNER LITE) COLOR OPTIONS: CLEAR/ CLEAR, CLEAR/ WHITE
FINISH:	MILL FINISH (STANDARD)
ALUMINUM:	EXTRUDED 6063-T5, GLAZING FRAME .075", GLAZING RETAINER .065"
FASTENERS:	STAINLESS STEEL AT GLAZING CAPS. ZINC PLATED AT STRUCTURAL CONNECTIONS. ALL FASTENERS NATURAL FINISH.
GASKET:	EPDM (BLACK)
SHIPPING:	FACTORY ASSEMBLED UNITS, READY TO MOUNT ONTO MODEL ICW CURB BY EXARC.
INSTALLATION:	BY OTHERS

MODEL: ICW INSULATED CURBS WITH WOOD NAILER	EXARC DESIGN, FACTORY ASSEMBLED, 1-1/8" WIDE DOUBLE WALL, 9" HIGH, INSULATED ALUMINUM CURBS WITH WOOD NAILER. 2-3/4" WIDE HORIZONTAL MOUNTING FLANGE ALL AROUND THE PERIMETER BASE OF THE CURB FOR FASTENING TO THE ROOF DECK. CURBS TO MOUNT OVER ROOF OPENINGS OF BY OTHERS. TOP OF CURBS TO BE FLAT TO RECEIVE EXARC SKYLIGHTS MODEL CMDD. OUTER CURB WALL CORNERS TO BE WELDED WATER TIGHT. CURBS TO BE SHIPPED SEPARATE FROM SKYLIGHTS IN ORDER THAT CURBS CAN BE INSTALLED AND FLASHED BY OTHERS PRIOR TO SKYLIGHT ATTACHMENT TO CURBS.
ALUMINUM:	OUTER CURB WALL - .075" THICK EXTRUDED ALUMINUM (6063) INNER CURB LINER - .030" THICK FORMED ALUMINUM (3003)
FINISH:	MILL FINISH ALUMINUM
INSULATION:	EXPANDED POLYSTYRENE FOAM
FASTENERS:	MOUNTING FASTENERS TO ROOF DECK BY OTHERS
SHIPPING:	FACTORY ASSEMBLED, READY TO MOUNT OVER ROOF OPENING
INSTALLATION:	BY OTHERS

SAFETY: FTP-FALL THROUGH PROTECTION	OSHA COMPLIANT FALL THROUGH PROTECTION AND BREAKAGE - EXARC MODEL CMDD-PRZ-FTP HAS BEEN LABORATORY TESTED AND FOUND TO BE IN COMPLIANCE WITH (OCCUPATIONAL SAFETY AND HEALTH ADMINISTRATION / U.S. DEPARTMENT OF LABOR REGULATIONS (STANDARDS-29 CFR)-1910.23 (E)(8)) REQUIREMENTS FOR FALL PROTECTION. UNIT SIZE TESTED 48" X 96"
----------------------------------------------	---------------------------------------------------------------------------------------------------------------------------------------------------------------------------------------------------------------------------------------------------------------------------------------------------------------------------------------

STANDARD SIZES:	UNIT NO.	ROOF OPENING (RECTANGULAR)	EXARC MODEL CMDD-PRZ-FTP HAS BEEN LABORATORY TESTED AND FOUND TO BE WITHIN THE RECOMMENDED PERFORMANCE VALUES FOR THE FOLLOWING TESTS: - AIR, WATER AND STRUCTURAL TESTING (AAMA/WDMA/CSA101/LS2/A440) USING ASTM E 283, ASTM E 330, AND ASTM E 331 TEST METHODS  -ASTM F588 FORCED ENTRY RESISTANCE  -FM 4431 - SIMULATED HAIL IMPACT RESISTANCE TEST USING 2" FREEZER ICE BALLS FIRED AT THE SAMPLE SKYLIGHT
	4848	44" X 44"	
	4872	44" X 68"	
	4896	44" X 92"	



EXARC SKYLIGHTS, INC.  
3793-B NORTH PEACHTREE RD.  
CHAMBLEE, GA 30341

WEBSITE: [www.exarcskylights.com](http://www.exarcskylights.com)

770-451-4352

800-247-5934

FAX: 770-451-4934

EMAIL: [info@exarcskylights.com](mailto:info@exarcskylights.com)

22S

PROJECT:  
CONTRACTOR:

DATE:

PAGE 2 OF 2

# 23. CMDD-IC: Curb Mount Double Dome Skylight with 12" High Insulated Curb with Interior Liner

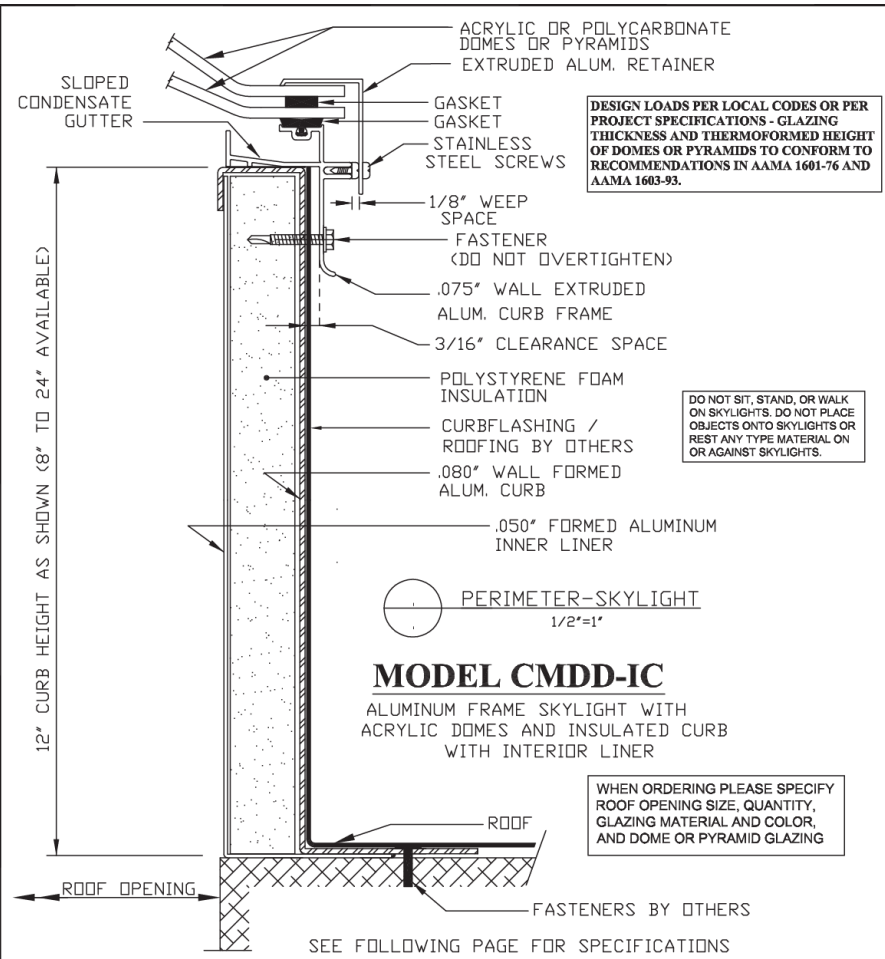

**MODEL CMDD-IC**  
ALUMINUM FRAME SKYLIGHT WITH ACRYLIC DOMES AND INSULATED CURB WITH INTERIOR LINER

## SPECIFICATIONS: MODEL CMDD-IC

MODEL: CMDD-IC	EXARC DESIGN, FACTORY ASSEMBLED, ALUMINUM FRAME, CURB MOUNT SKYLIGHT WITH THERMOFORMED, 25% RISE DOMES OR PYRAMIDS, TO MOUNT ONTO AN EXARC DESIGN, 12" HIGH INSULATED CURB, TO FIT OVER SPECIFIED SIZE ROOF OPENING.
GLAZING:	THERMOFORMED ACRYLIC OR POLYCARBONATE DOME OR PYRAMID (OUTER LITE) THERMOFORMED ACRYLIC OR POLYCARBONATE DOME OR PYRAMID (INNER LITE) COLOR OPTIONS: CLEAR/CLEAR, CLEAR/WHITE, BRONZE/CLEAR
FINISH:	MILL FINISH (STANDARD)
ALUMINUM:	EXTRUDED 6063-T5, GLAZING FRAME .075", GLAZING RETAINER .065"
FASTENERS:	STAINLESS STEEL AT GLAZING CAPS. ZINC PLATED AT STRUCTURAL CONNECTIONS. ALL FASTENERS NATURAL FINISH.
GASKET:	EPDM (BLACK)
SHIPPING:	FACTORY ASSEMBLED UNITS, READY TO MOUNT ONTO MODEL IC CURB BY EXARC.
INSTALLATION:	BY OTHERS

MODEL: IC INSULATED CURBS	EXARC DESIGN, FACTORY ASSEMBLED, 1-1/4" WIDE DOUBLE WALL, 12" HIGH, INSULATED ALUMINUM CURBS. 3" WIDE HORIZONTAL MOUNTING FLANGE ALL AROUND THE PERIMETER BASE OF THE CURB FOR FASTENING TO THE ROOF DECK. CURBS TO MOUNT OVER ROOF OPENINGS BY OTHERS. TOP OF CURBS TO BE FLAT TO RECEIVE EXARC SKYLIGHTS MODEL CMDD. OUTER CURB WALL CORNERS TO BE WELDED WATER TIGHT. CURBS TO BE SHIPPED UN-ATTACHED FROM SKYLIGHTS IN ORDER THAT CURBS CAN BE INSTALLED AND FLASHED BY OTHERS PRIOR TO SKYLIGHT PERMANENT ATTACHMENT TO CURBS.
ALUMINUM:	OUTER CURB WALL -.080" THICK FORMED ALUMINUM (3003) INNER CURB WALL -.050" THICK FORMED ALUMINUM (3003)
FINISH:	MILL FINISH ALUMINUM
INSULATION:	EXPANDED POLYSTYRENE FOAM
FASTENERS:	MOUNTING FASTENERS TO ROOF DECK BY OTHERS
SHIPPING:	FACTORY ASSEMBLED, READY TO MOUNT OVER ROOF OPENING
INSTALLATION:	BY OTHERS
SAFETY:	FALL THROUGH AND BREAKAGE - STANDARD DESIGN ACRYLIC OR POLYCARBONATE GLAZING ARE NOT INTENDED TO SUPPORT THE WEIGHT OF A PERSON OR ANY OTHER LOAD IMPOSED UPON THE SKYLIGHT. IF THE PROJECT LOCATION INDICATES THAT THE SKYLIGHTS MAY BE SUBJECT TO INCIDENTAL OR UNINTENDED LIVE LOADS, OR IF THE PROJECT SKYLIGHT SPECIFICATIONS INDICATE THAT OSHA APPROVED FALL THROUGH PROTECTION ARE TO BE INTEGRAL TO THE SKYLIGHT DESIGN, FOR CERTAIN SIZE SKYLIGHTS EXARC CAN SUPPLY LABORATORY TESTED GLAZING OR PROTECTIVE SCREEN COVERS THAT ARE IN COMPLIANCE WITH OSHA FALL THROUGH PROTECTION REQUIREMENTS. SEE OUR SKYLIGHTS THAT INCLUDE "FTF" IN THE MODEL NUMBER.

STANDARD SIZES:	UNIT NO.	ROOF OPENING (RECTANGULAR)	UNIT NO.	ROOF OPENING (SQUARE)	GLAZING OPTIONS MODEL NUMBERS
NOTE: ANY CUSTOM SIZE IS AVAILABLE UP TO 98" X 98" ROOF OPENING	3672	32" X 68"	4848	44" X 44"	CMDD-IC DOUBLE DOME
	3696	32" X 92"	5252	48" X 48"	CMDD-IC SINGLE DOME
	4872	44" X 68"	6060	56" X 56"	CMPP-IC DOUBLE PYRAMID
	4896	44" X 92"	7272	68" X 68"	CMSP-IC SINGLE PYRAMID
	5276	48" X 72"	9696	92" X 92"	
	5296	48" X 92"	52102	48" X 98"	



**EXARC SKYLIGHTS, INC.**  
3793-B NORTH PEACHTREE RD.  
CHAMBLEE, GA 30341  
WEBSITE: [www.exarcskylights.com](http://www.exarcskylights.com)

770-451-4352  
800-247-5934  
FAX: 770-451-4934  
EMAIL: [info@exarcskylights.com](mailto:info@exarcskylights.com)

PROJECT: \_\_\_\_\_ DATE: \_\_\_\_\_

CONTRACTOR: \_\_\_\_\_

23C

PAGE 1 OF 2



**EXARC SKYLIGHTS, INC.**  
3793-B NORTH PEACHTREE RD.  
CHAMBLEE, GA 30341  
WEBSITE: [www.exarcskylights.com](http://www.exarcskylights.com)

770-451-4352  
800-247-5934  
FAX: 770-451-4934  
EMAIL: [info@exarcskylights.com](mailto:info@exarcskylights.com)

PROJECT: \_\_\_\_\_ DATE: \_\_\_\_\_

CONTRACTOR: \_\_\_\_\_

23S

PAGE 2 OF 2



24. **CMDD-IC-FTP:** Curb Mount, Double Dome, OSHA Compliant Fall Through Protection Skylight and 12" High Insulated Curb with Liner

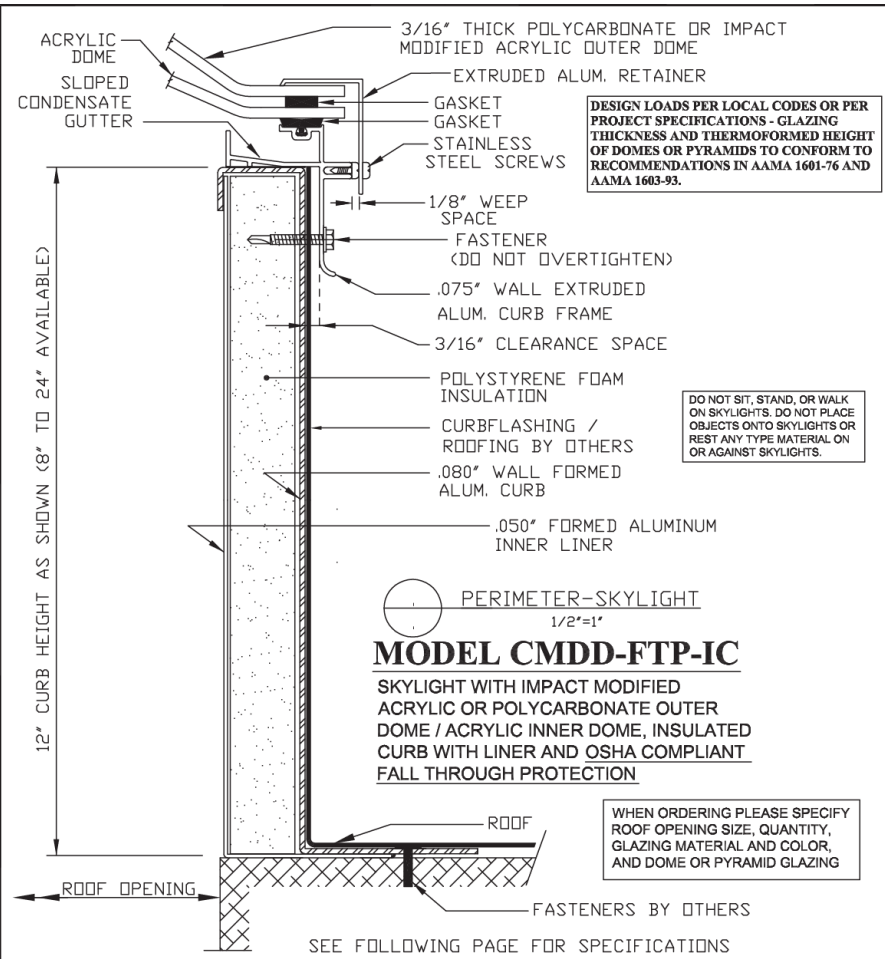

**MODEL CMDD-FTP-IC**  
SKYLIGHT WITH IMPACT MODIFIED ACRYLIC OR POLYCARBONATE OUTER DOME / ACRYLIC INNER DOME, INSULATED CURB WITH LINER AND OSHA COMPLIANT FALL THROUGH PROTECTION

**SPECIFICATIONS: MODEL CMDD-FTP-IC**

MODEL:	CMDD-FTP-IC
GLAZING:	EXARC DESIGN, FACTORY ASSEMBLED, ALUMINUM FRAME, CURB MOUNT SKYLIGHT WITH FALL THROUGH PROTECTION THERMOFORMED, 25 % RISE DOMES, TO MOUNT ONTO AN EXARC DESIGN, 12" HIGH INSULATED CURB, TO FIT OVER SPECIFIED SIZE ROOF OPENING.
FINISH:	THERMOFORMED MODIFIED ACRYLIC OR POLYCARBONATE DOME (OUTER LITE) THERMOFORMED ACRYLIC OR POLYCARBONATE DOME (INNER LITE) COLOR OPTIONS: CLEAR/CLEAR, CLEAR/WHITE, BRONZE/CLEAR
ALUMINUM:	MILL FINISH (STANDARD)
FASTENERS:	EXTRUDED 6063-T5, GLAZING FRAME .075", GLAZING RETAINER .065"
GASKET:	STAINLESS STEEL AT GLAZING CAPS. ZINC PLATED AT STRUCTURAL CONNECTIONS. ALL FASTENERS NATURAL FINISH.
SHIPPING:	EPDM (BLACK)
INSTALLATION:	FACTORY ASSEMBLED UNITS, READY TO MOUNT ONTO MODEL IC CURB BY EXARC.

MODEL:	IC INSULATED CURBS
ALUMINUM:	EXARC DESIGN, FACTORY ASSEMBLED, 1-1/4" WIDE DOUBLE WALL, 12" HIGH, INSULATED ALUMINUM CURBS. 3" WIDE HORIZONTAL MOUNTING FLANGE ALL AROUND THE PERIMETER BASE OF THE CURB FOR FASTENING TO THE ROOF DECK. CURBS TO MOUNT OVER ROOF OPENINGS BY OTHERS. TOP OF CURBS TO BE FLAT TO RECEIVE EXARC SKYLIGHTS MODEL CMDD. OUTER CURB WALL CORNERS TO BE WELDED WATER TIGHT. CURBS TO BE SHIPPED UN-ATTACHED FROM SKYLIGHTS IN ORDER THAT CURBS CAN BE INSTALLED AND FLASHED BY OTHERS PRIOR TO SKYLIGHT PERMANENT ATTACHMENT TO CURBS.
FINISH:	OUTER CURB WALL - .080" THICK FORMED ALUMINUM (3003) INNER CURB WALL - .050" THICK FORMED ALUMINUM (3003)
INSULATION:	MILL FINISH ALUMINUM
FASTENERS:	EXPANDED POLYSTYRENE FOAM
SHIPPING:	MOUNTING FASTENERS TO ROOF DECK BY OTHERS
INSTALLATION:	FACTORY ASSEMBLED, READY TO MOUNT OVER ROOF OPENING

SAFETY:	OSHA COMPLIANT FALL THROUGH PROTECTION AND BREAKAGE -
FTP-FALL THROUGH PROTECTION	EXARC MODEL CMDD-FTP HAS BEEN LABORATORY TESTED AND FOUND TO BE IN COMPLIANCE WITH (OCCUPATIONAL SAFETY AND HEALTH ADMINISTRATION / U.S. DEPARTMENT OF LABOR REGULATIONS (STANDARDS-29 CFR)-1910.23 (E)(8)) REQUIREMENTS FOR FALL PROTECTION. 10/15/07. UNIT SIZE TESTED 54" X 110"

STANDARD SIZES:	UNIT NO.	ROOF OPENING (RECTANGULAR)	UNIT NO.	ROOF OPENING (SQUARE)
NOTE: ANY CUSTOM SIZE IS AVAILABLE UP TO 50" X 106" ROOF OPENING	3672	32" X 68"	4848	44" X 44"
	3696	32" X 92"	5252	48" X 48"
	4872	44" X 68"		
	4896	44" X 92"		
	5276	48" X 72"		
	5296	48" X 92"		
	52102	48" X 98"		



**EXARC SKYLIGHTS, INC.**  
3793-B NORTH PEACHTREE RD.  
CHAMBLEE, GA 30341  
WEBSITE: [www.exarcskylights.com](http://www.exarcskylights.com)

770-451-4352  
800-247-5934  
FAX: 770-451-4934  
EMAIL: [info@exarcskylights.com](mailto:info@exarcskylights.com)



**EXARC SKYLIGHTS, INC.**  
3793-B NORTH PEACHTREE RD.  
CHAMBLEE, GA 30341  
WEBSITE: [www.exarcskylights.com](http://www.exarcskylights.com)

770-451-4352  
800-247-5934  
FAX: 770-451-4934  
EMAIL: [info@exarcskylights.com](mailto:info@exarcskylights.com)

PROJECT: \_\_\_\_\_ DATE: \_\_\_\_\_  
CONTRACTOR: \_\_\_\_\_

PAGE 1 OF 2

PROJECT: \_\_\_\_\_ DATE: \_\_\_\_\_  
CONTRACTOR: \_\_\_\_\_

PAGE 2 OF 2

25. **CMDD-PRZ-FTP-IC:** Curb Mount, Double Polycarbonate Prismatic Dome, OSHA Compliant Fall Through Protection Skylight and Insulated Curb with Interior Aluminum Curb Liner

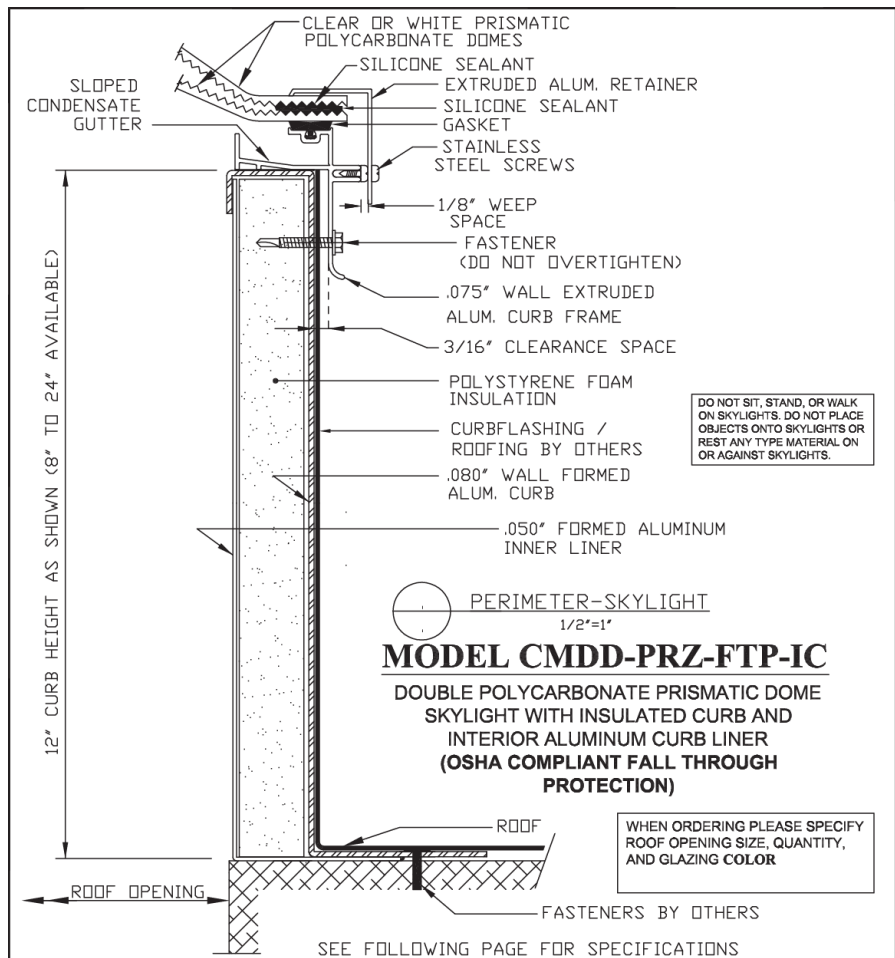

**SPECIFICATIONS: MODEL CMDD-PRZ-FTP-IC**

MODEL: CMDD-PRZ-FTP-IC	EXARC DESIGN, FACTORY ASSEMBLED, ALUMINUM FRAME, CURB MOUNT SKYLIGHT WITH THERMOFORMED, PRISMATIC POLYCARBONATE DOMES, TO MOUNT ONTO AN EXARC DESIGN, 12" HIGH INSULATED CURB, TO FIT OVER SPECIFIED SIZE ROOF OPENING.
GLAZING:	THERMOFORMED DOME (OUTER LITE) - THICK PRISMATIC POLYCARBONATE THERMOFORMED DOME (INNER LITE) - THICK PRISMATIC POLYCARBONATE COLOR OPTIONS: CLEAR/CLEAR, CLEAR/WHITE
FINISH:	MILL FINISH (STANDARD)
ALUMINUM:	EXTRUDED 6063-T5, GLAZING FRAME .075", GLAZING RETAINER .065"
FASTENERS:	STAINLESS STEEL AT GLAZING CAPS. ZINC PLATED AT STRUCTURAL CONNECTIONS. ALL FASTENERS NATURAL FINISH.
GASKET:	EPDM (BLACK)
SHIPPING:	FACTORY ASSEMBLED UNITS, READY TO MOUNT ONTO MODEL IC CURB BY EXARC.
INSTALLATION:	BY OTHERS

MODEL: IC INSULATED CURBS	EXARC DESIGN, FACTORY ASSEMBLED, 1-1/4" WIDE DOUBLE WALL, 12" HIGH, INSULATED ALUMINUM CURBS. 3" WIDE HORIZONTAL MOUNTING FLANGE ALL AROUND THE PERIMETER BASE OF THE CURB FOR FASTENING TO THE ROOF DECK. CURBS TO MOUNT OVER ROOF OPENINGS BY OTHERS. TOP OF CURBS TO BE FLAT TO RECEIVE EXARC SKYLIGHTS MODEL CMDD. OUTER CURB WALL CORNERS TO BE WELDED WATER TIGHT. <u>CURBS TO BE SHIPPED UN-ATTACHED FROM SKYLIGHTS IN ORDER THAT CURBS CAN BE INSTALLED AND FLASHED BY OTHERS PRIOR TO SKYLIGHT PERMANENT ATTACHMENT TO CURBS.</u>
ALUMINUM:	OUTER CURB WALL - .080" THICK FORMED ALUMINUM (3003) INNER CURB WALL - .050" THICK FORMED ALUMINUM (3003)
FINISH:	MILL FINISH ALUMINUM
INSULATION:	EXPANDED POLYSTYRENE FOAM
FASTENERS:	MOUNTING FASTENERS TO ROOF DECK BY OTHERS
SHIPPING:	FACTORY ASSEMBLED, READY TO MOUNT OVER ROOF OPENING
INSTALLATION:	BY OTHERS
SAFETY: FTP-FALL THROUGH PROTECTION	OSHA COMPLIANT FALL THROUGH PROTECTION AND BREAKAGE - EXARC MODEL CMDD-PRZ-FTP HAS BEEN LABORATORY TESTED AND FOUND TO BE IN COMPLIANCE WITH (OCCUPATIONAL SAFETY AND HEALTH ADMINISTRATION / U.S. DEPARTMENT OF LABOR REGULATIONS (STANDARDS-29 CFR)-1910.23 (E)(8)) REQUIREMENTS FOR FALL PROTECTION. UNIT SIZE TESTED 48" X 96"

STANDARD SIZES:	UNIT NO.	ROOF OPENING (RECTANGULAR)	EXARC MODEL CMDD-PRZ-FTP HAS BEEN LABORATORY TESTED AND FOUND TO BE WITHIN THE RECOMMENDED PERFORMANCE VALUES FOR THE FOLLOWING TESTS: - AIR, WATER AND STRUCTURAL TESTING (AAMA/WDMA/CSA101/LS2/A440) USING ASTM E 283, ASTM E 330, AND ASTM E 331 TEST METHODS  -ASTM F588 FORCED ENTRY RESISTANCE  -FM 4431 - SIMULATED HAIL IMPACT RESISTANCE TEST USING 2" FREEZER ICE BALLS FIRED AT THE SAMPLE SKYLIGHT
	4848	44" X 44"	
	4872	44" X 68"	
	4896	44" X 92"	



**EXARC SKYLIGHTS, INC.**  
3793-B NORTH PEACHTREE RD.  
CHAMBLEE, GA 30341  
WEBSITE: [www.exarcskylights.com](http://www.exarcskylights.com)

770-451-4352  
800-247-5934  
FAX: 770-451-4934  
EMAIL: [info@exarcskylights.com](mailto:info@exarcskylights.com)

PROJECT: \_\_\_\_\_ DATE: \_\_\_\_\_

CONTRACTOR: \_\_\_\_\_

PAGE 1 OF 2



**EXARC SKYLIGHTS, INC.**  
3793-B NORTH PEACHTREE RD.  
CHAMBLEE, GA 30341  
WEBSITE: [www.exarcskylights.com](http://www.exarcskylights.com)

770-451-4352  
800-247-5934  
FAX: 770-451-4934  
EMAIL: [info@exarcskylights.com](mailto:info@exarcskylights.com)

PROJECT: \_\_\_\_\_ DATE: \_\_\_\_\_

CONTRACTOR: \_\_\_\_\_

PAGE 2 OF 2



26. **LRV-IC:** Low Rise Vault on 12" High Insulated Curb

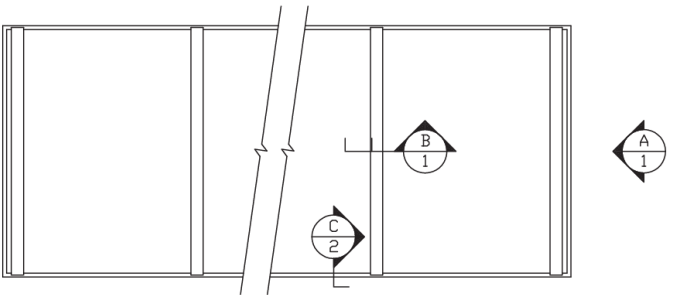

PLAN - LOW RISE VAULT SKYLIGHT  
ON INSULATED CURB

MODEL LRV-IC

+/- 1/2" = 1'-0"

DO NOT SIT, STAND, OR WALK  
ON SKYLIGHTS. DO NOT PLACE  
OBJECTS ONTO SKYLIGHTS OR  
REST ANY TYPE MATERIAL ON  
OR AGAINST SKYLIGHTS.



(A)  
1 END ELEVATION  
SKYLIGHT  
+/- 1/2" = 1'-0"

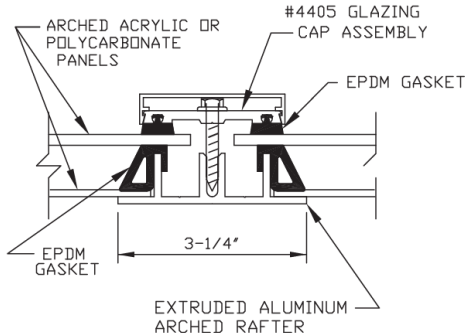

(B)  
1 SECTION ARCHED  
RAFTER ASSEMBLY  
1/2"=1'

**MODEL LRV-IC**



EXARC SKYLIGHTS, INC.  
3793-B NORTH PEACHTREE RD.  
CHAMBLEE, GA 30341  
WEBSITE: [www.exarcskylights.com](http://www.exarcskylights.com)

770-451-4352  
800-247-5934  
FAX: 770-451-4934  
EMAIL: [info@exarcskylights.com](mailto:info@exarcskylights.com)

26C

PROJECT:  
CONTRACTOR:

DATE:

**SPECIFICATIONS: MODEL LRV-IC**

MODEL: LRV-IC	EXARC DESIGN, FACTORY ASSEMBLED, ALUMINUM FRAME, LOW RISE VAULT SKYLIGHT WITH VERTICAL GLAZED ENDS IS A CONTINUOUS ARCHED SKYLIGHT WHICH MOUNTS ONTO A FLAT LEVEL FLASHED CURB BY EXARC **. GLAZING TO BE COLD FORMED ACRYLIC OR POLYCARBONATE PANELS. CURB TO BE AN EXARC DESIGN, 12" HIGH INSULATED CURB, TO FIT OVER SPECIFIED SIZE ROOF OPENING. CROSS TIES AT CURBS REQUIRED FOR UNITS LONGER THAN 8'-0". TYPICAL BAY CENTERS FOR ARCHED SKYLIGHT RAFTERS 42". MAXIMUM ROOF OPENING WIDTH 48", LENGTH UNLIMITED. LONGER LENGTH SKYLIGHTS TO SHIP IN FACTORY ASSEMBLED MODULES (MAX. 17'6" LONG) CURBS TO SHIP SEPARATELY (KNOCKED DOWN). ** EXARC MODEL LRV CAN BE PROVIDED TO MOUNT ONTO FLASHED CURBS BY OTHERS UP TO 6'-0" WIDE. SEE SKYLIGHT MODEL LRV IN "SKYLIGHT SPECIALTIES" IN THIS WEBSITE FOR MORE INFORMATION.
GLAZING:	DOUBLE OR SINGLE GLAZING OF ACRYLIC OR POLYCARBONATE COLD FORMED PANELS. COLOR OPTIONS: CLEAR/ CLEAR, CLEAR/ WHITE, BRONZE/ CLEAR
FINISH:	MILL FINISH (STANDARD), POWDER COATED BRONZE PAINT, STANDARD COLOR KYNAR
ALUMINUM:	EXTRUDED 6063-T5,
FASTENERS:	STAINLESS STEEL AT GLAZING CAPS. ZINC PLATED AT STRUCTURAL CONNECTIONS. ALL FASTENERS NATURAL FINISH.
GASKET:	EPDM (BLACK)
SHIPPING:	FACTORY ASSEMBLED UNITS, READY TO MOUNT ONTO MODEL IC CURB BY EXARC.
INSTALLATION:	BY OTHERS

MODEL: IC INSULATED CURBS	EXARC DESIGN, FACTORY ASSEMBLED, 1-1/4" WIDE DOUBLE WALL, 12" HIGH, INSULATED ALUMINUM CURBS. 3" WIDE HORIZONTAL MOUNTING FLANGE ALL AROUND THE PERIMETER BASE OF THE CURB FOR FASTENING TO THE ROOF DECK. CURBS TO MOUNT OVER ROOF OPENINGS BY OTHERS. TOP OF CURBS TO BE FLAT TO RECEIVE EXARC SKYLIGHTS MODEL LRV. CURBS TO BE SHIPPED UN-ATTACHED FROM SKYLIGHTS IN ORDER THAT CURBS CAN BE INSTALLED AND FLASHED BY OTHERS PRIOR TO SKYLIGHT PERMANENT ATTACHMENT TO CURBS.
ALUMINUM:	OUTER CURB WALL - .080" THICK FORMED ALUMINUM (3003) INNER CURB WALL - .050" THICK FORMED ALUMINUM (3003)
FINISH:	MILL FINISH ALUMINUM
INSULATION:	EXPANDED POLYSTYRENE FOAM
FASTENERS:	MOUNTING FASTENERS TO ROOF DECK BY OTHERS
SHIPPING:	FACTORY ASSEMBLED ( KNOCKED DOWN MODULES FOR LONGER LENGTH SYLIGTS), READY TO MOUNT OVER ROOF OPENING
INSTALLATION:	BY OTHERS
SAFETY:	FALL THROUGH AND BREAKAGE - STANDARD DESIGN ACRYLIC OR POLYCARBONATE GLAZING ARE NOT INTENDED TO SUPPORT THE WEIGHT OF A PERSON OR ANY OTHER LOAD IMPOSED UPON THE SKYLIGHT. IF THE PROJECT LOCATION INDICATES THAT THE SKYLIGHTS MAY BE SUBJECTED TO INCIDENTAL OR UNINTENDED LIVE LOADS, EXARC CAN SUPPLY PROTECTIVE SCREEN COVERS. SEE OUR MODEL NUMBER PSC.



EXARC SKYLIGHTS, INC.  
3793-B NORTH PEACHTREE RD.  
CHAMBLEE, GA 30341  
WEBSITE: [www.exarcskylights.com](http://www.exarcskylights.com)

770-451-4352  
800-247-5934  
FAX: 770-451-4934  
EMAIL: [info@exarcskylights.com](mailto:info@exarcskylights.com)

26S

PROJECT:  
CONTRACTOR:

DATE:

26.1. **LRV-IC:** Low Rise Vault with Acrylic Panels and Aluminum Frame, 12" High Insulated Curb, with Interior Liner

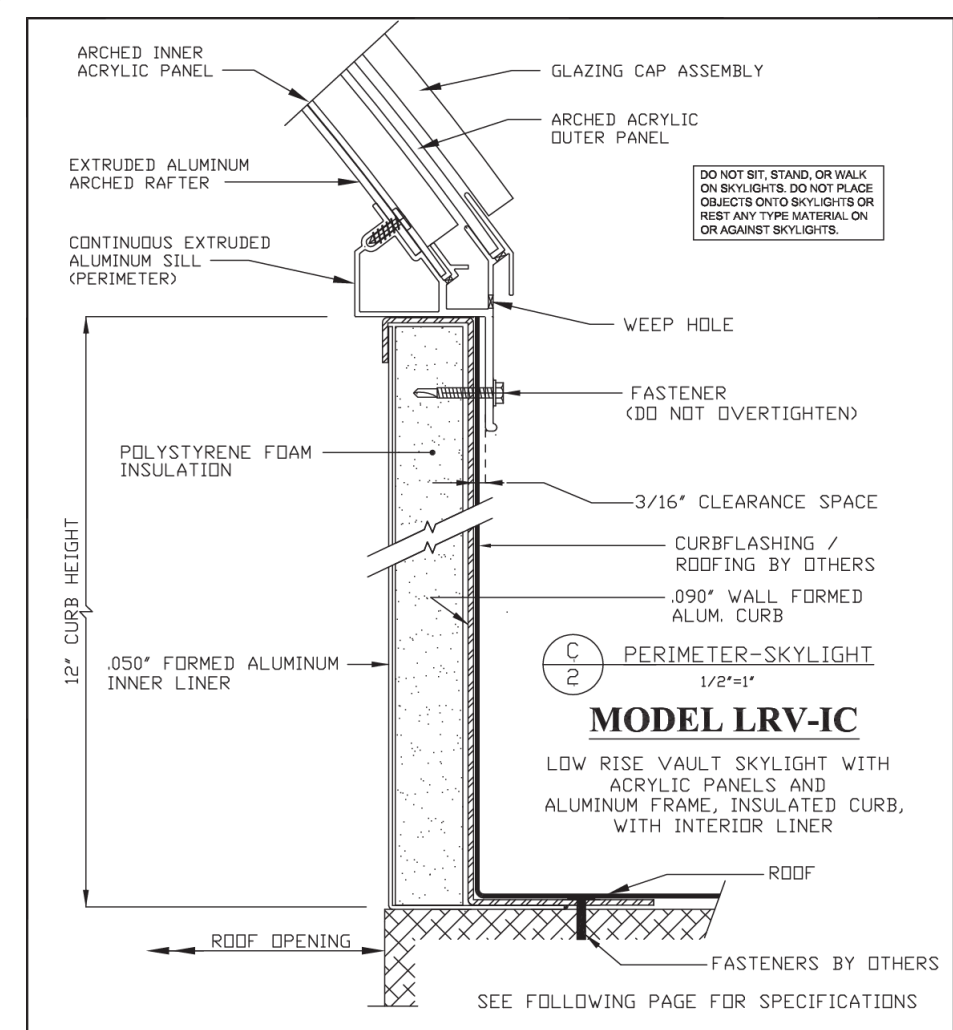

EXARC SKYLIGHTS, INC.  
3793-B NORTH PEACHTREE RD.  
CHAMBLEE, GA 30341

WEBSITE: [www.exarcskylights.com](http://www.exarcskylights.com)

770-451-4352  
800-247-5934  
FAX: 770-451-4934

EMAIL: [info@exarcskylights.com](mailto:info@exarcskylights.com)

26.1C

PROJECT:  
CONTRACTOR:

DATE:

PAGE 2 OF 3